

INDEX				
SHEET	DRAWING NO.	DRAWING TITLE	REV.	REV. DATE
1	RLGL-001	INDEX	2.0	11/1/2015
2	RLGL-002	PICTORIAL BOM	2.0	11/1/2015
3	RLGL-003	ARRANGEMENT	2.0	11/1/2015
4	RLGL-004	SENSOR LOCATION	2.0	11/1/2015
5	RLGL-005	TUBE SENSOR LINE	2.0	11/1/2015
6	RLGL-006	BODY SENSOR LINE	2.0	11/1/2015
7	RLGL-007	SENSOR AND BRACKET ASSEMBLY	2.0	11/1/2015
8	RLGL-008	SENSOR AND BRACKET ASSEMBLY	2.0	11/1/2015
9	RLGL-009	LENS INSTALLATION	2.0	11/1/2015
10	RLGL-010	INTERCONNECTION DIAGRAM	2.0	11/1/2015
11	RLGL-011	UPPER J-BOX	2.0	11/1/2015
12	RLGL-012	LOWER J-BOX	2.0	11/1/2015
13	RLGL-013	CONTROL BOX	2.0	11/1/2015
14	RLGL-014	PAUSE BUTTON	2.0	11/1/2015
15	RLGL-015	RED/GREEN LIGHT	2.0	11/1/2015
16	RLGL-016	ACCESSORIES	2.0	11/1/2015
17	RLGL-017	SCHEMATIC	2.0	11/1/2015
18	RLGL-018	SCHEMATIC	2.0	11/1/2015
19	RLGL-019	SCHEMATIC	2.0	11/1/2015
20	RLGL-020	SCHEMATIC	2.0	11/1/2015

EXAMPLE OF LINE REFERENCES:

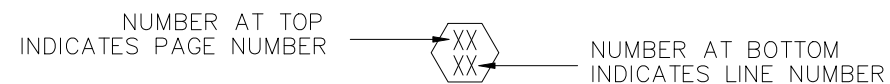

NOTES:

PRODUCT

RED LIGHT GREEN LIGHT

REV.	DATE	DESCRIPTION	BY
20	11/1/2015	EXPANDED STANDARD PRODUCT FOR ADDITIONAL OPTIONS	MS



DRAWN	MS	DATE	11/1/2015	SCALE	NONE	REV.	2.0
CHECKED	SF	DATE	12/1/2015				
DRAWING TITLE						DWG. NO.	
INDEX						RLGL-001	

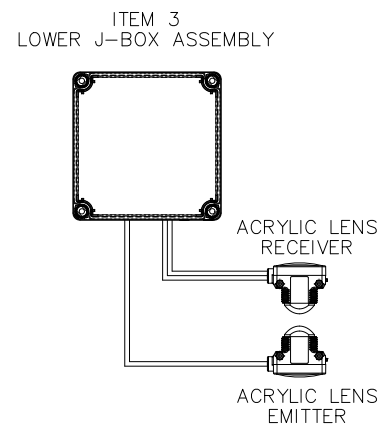
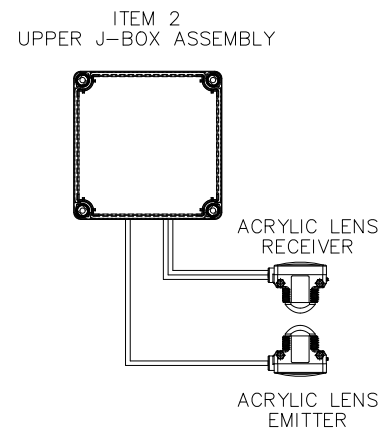
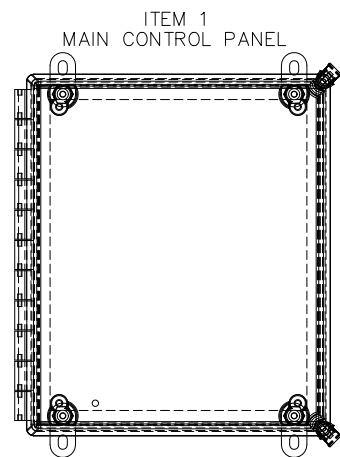

ITEM 5  
RLGL SIGNAL HEAD ASSEMBLY

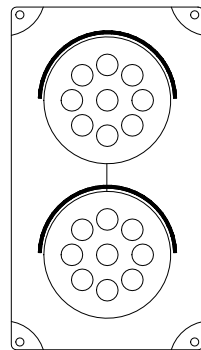

ITEM 6  
SENSOR PAIR MOUNTING KIT

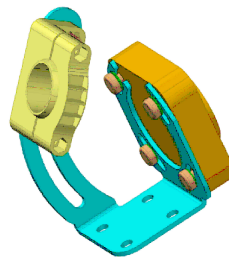

ITEM 7  
SENSOR APERTURES

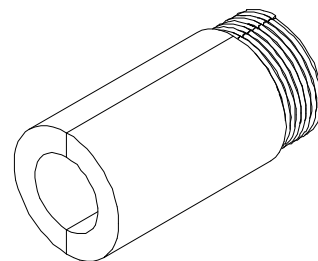

PICTORIAL BILL OF MATERIAL

ITEM	PART NUMBER	DESCRIPTION	QTY
1	20001	MAIN CONTROL PANEL	1
2	20013	UPPER J-BOX ASSEMBLY	1
3	20014	LOWER J-BOX ASSEMBLY	1
4	20015	PAUSE BUTTON ASSEMBLY	1
5	20003	RLGL SIGNAL HEAD ASSEMBLY	1
6	40002	SENSOR PAIR MOUNTING KIT	2
7	10021	SENSOR APERTURES	4

NOTES:

PRODUCT

RED LIGHT GREEN LIGHT

REV.	DATE	DESCRIPTION	BY
20	11/1/2015	EXPANDED STANDARD PRODUCT FOR ADDITIONAL OPTIONS	MS



DRAWN	MS	DATE	11/1/2015	SCALE	NONE	REV.	2.0
CHECKED	SF	DATE	12/1/2015				
DRAWING TITLE						DWG. NO.	
PICTORIAL BOM						RLGL-002	

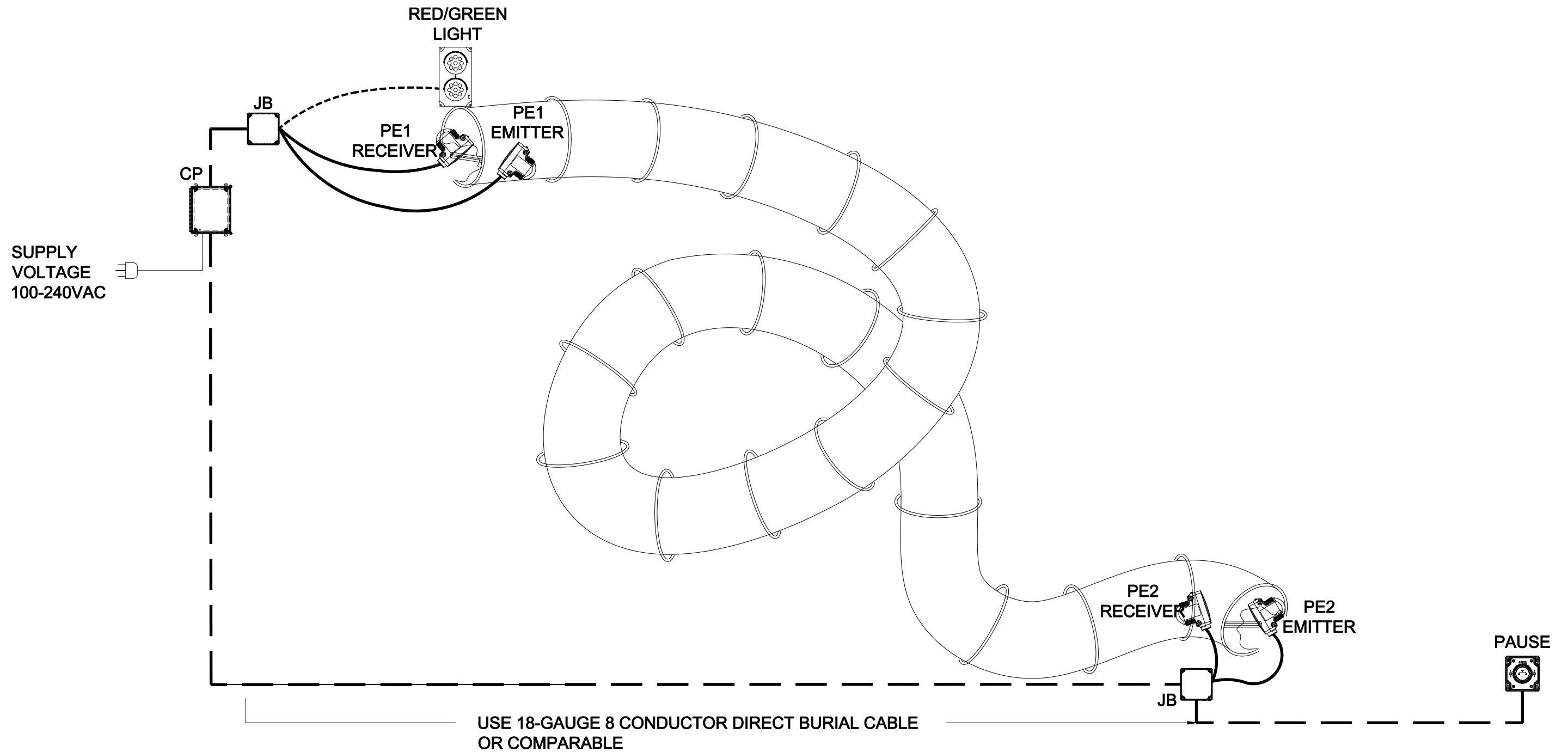

NOTES:

PRODUCT

RED LIGHT GREEN LIGHT

REV.	DATE	DESCRIPTION	BY
20	11/1/2015	EXPANDED STANDARD PRODUCT FOR ADDITIONAL OPTIONS	MS



DRAWN	MS	DATE	11/1/2015	SCALE	NONE	REV.	2.0
CHECKED	SF	DATE	12/1/2015				
DRAWING TITLE						DWG. NO.	
ARRANGEMENT						RLGL-003	

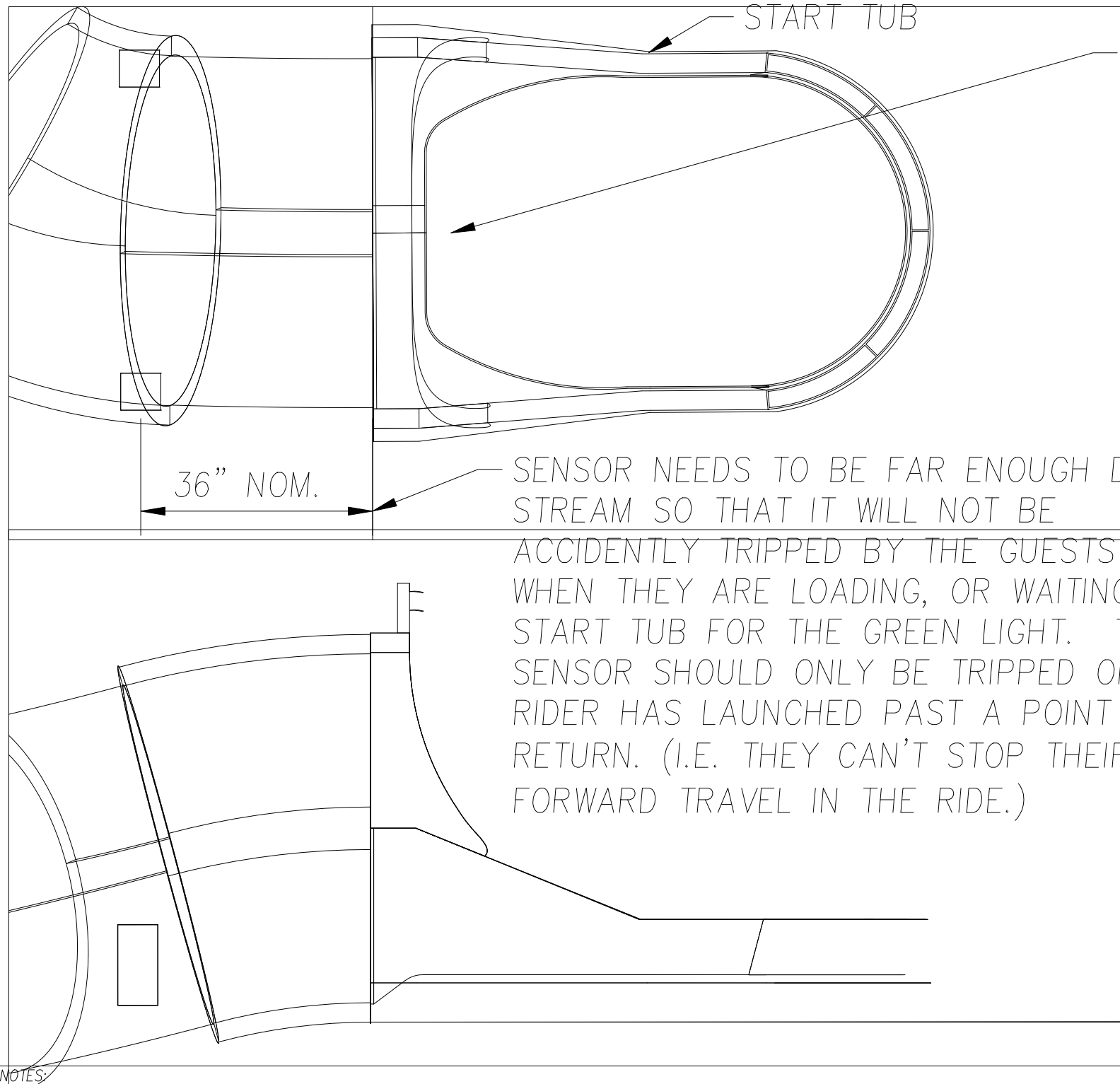

LOCATION OF RL/GL SIGNAL DEPENDS ON HOW THE RIDE WILL OPERATE. SIGNAL NEEDS TO BE PLACED SO THAT GUARDS CAN SEE IT WHILE THEY LOAD AND DISPATCH THE GUESTS. THE BEST PLACE MAY BE BEHIND THE START TUB AND NOT ON THE SLIDE DEPENDING ON THE RIDE.

SENSOR NEEDS TO BE FAR ENOUGH DOWN STREAM SO THAT IT WILL NOT BE ACCIDENTLY TRIPPED BY THE GUESTS FEET WHEN THEY ARE LOADING, OR WAITING IN THE START TUB FOR THE GREEN LIGHT. THE SENSOR SHOULD ONLY BE TRIPPED ONCE THE RIDER HAS LAUNCHED PAST A POINT OF NO RETURN. (I.E. THEY CAN'T STOP THEIR FORWARD TRAVEL IN THE RIDE.)

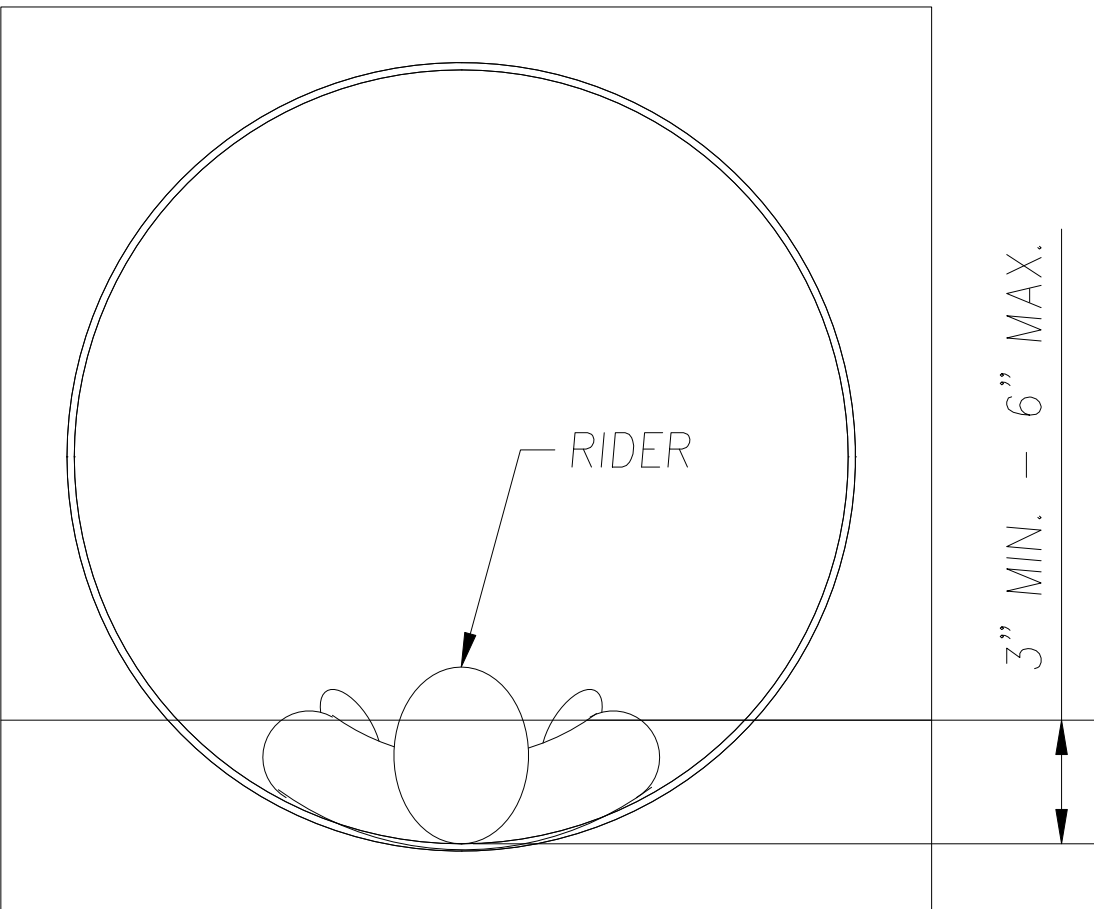

NOTES:

PRODUCT				RED LIGHT GREEN LIGHT			
DRAWN	MS	DATE	11/1/2015	SCALE	NONE	REV.	2.0
CHECKED	SF	DATE	12/1/2015				
DRAWING TITLE						DWG. NO.	
SENSOR LOCATION						RLGL-004	

REV.	DATE	DESCRIPTION	BY
20	11/1/2015	EXPANDED STANDARD PRODUCT FOR ADDITIONAL OPTIONS	MS



# DETERMINE OPTIMUM SENSOR LINE HEIGHT

## TUBE SLIDE

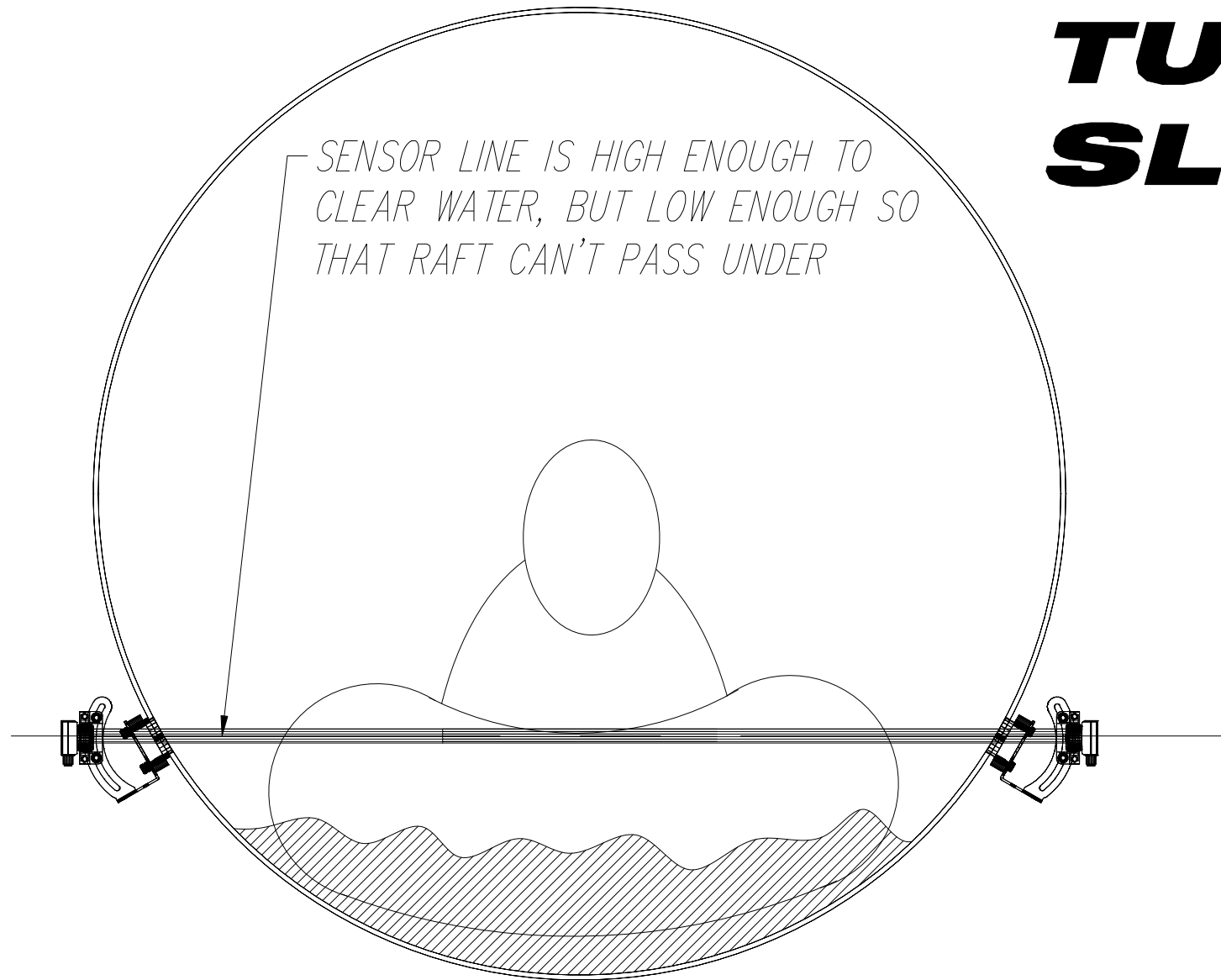

**GOOD!**

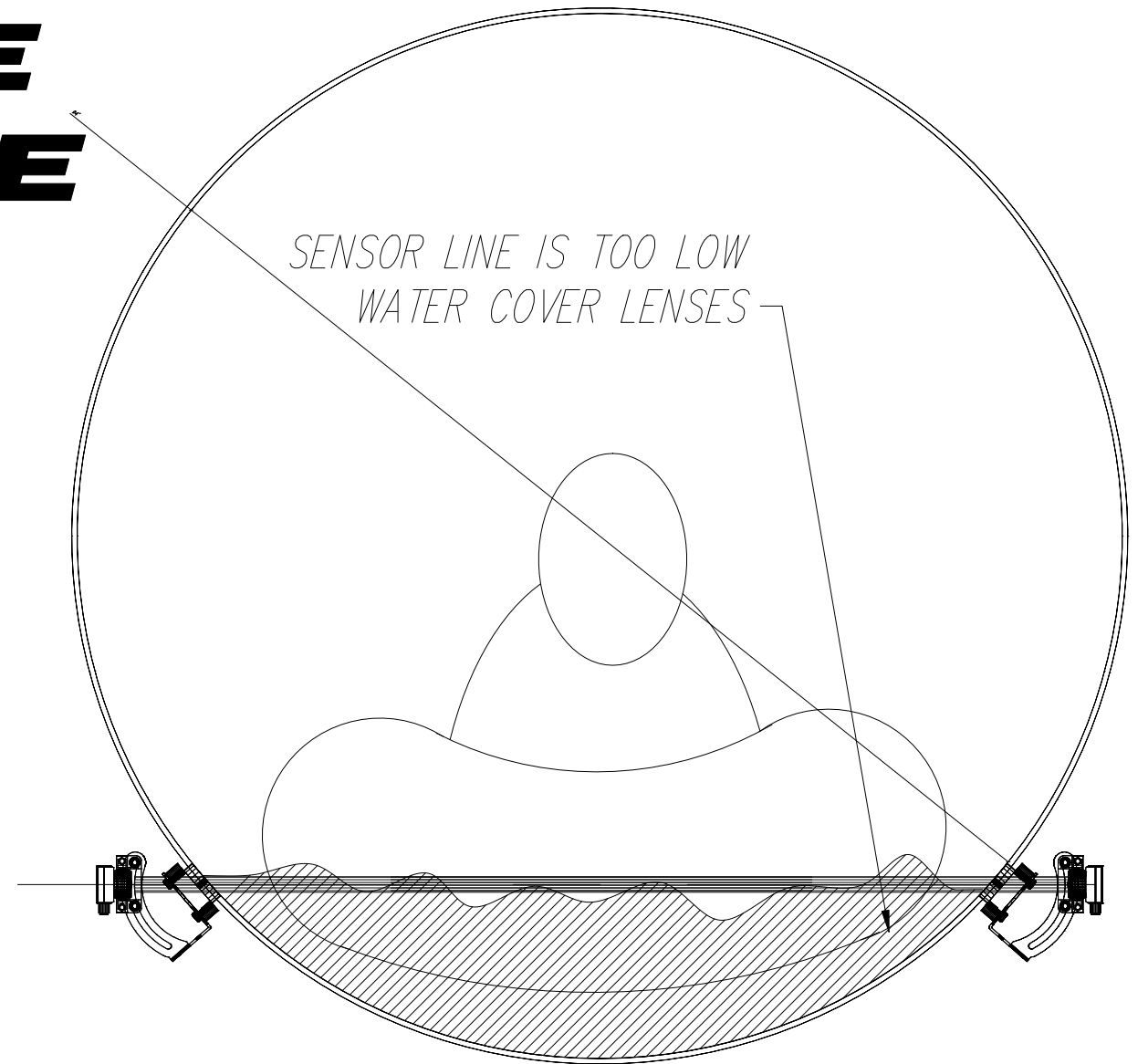

**NOT SO GOOD**

NOTES:

PRODUCT

RED LIGHT GREEN LIGHT

REV.	DATE	DESCRIPTION	BY
20	11/1/2015	EXPANDED STANDARD PRODUCT FOR ADDITIONAL OPTIONS	MS



DRAWN	MS	DATE	11/1/2015	SCALE	NONE	REV.	2.0
CHECKED	SF	DATE	12/1/2015	DRAWING TITLE		DWG. NO.	
TUBE SENSOR LINE						RLGL-005	

# DETERMINE OPTIMUM SENSOR LINE HEIGHT

SENSOR LINE IS LOW ENOUGH SO THAT RIDER CAN'T PASS UNDER, AND HIGH ENOUGH TO CLEAR WATER. SOME WATER OVER THE LENSE IS OK. RIDER NEEDS TO FULLY BREAK BEAM WITH BODY.

SUGGESTION ONLY! ACTUAL HEIGHT WILL VARY DEPENDING ON SLIDE DIAMETER. DRAW FULL SCALE CIRCLE REPRESENTING FLUME DIAMETER ON GROUND OR CARDBOARD AND CHECK SENSOR RANGE OF MOVEMENT IN BRACKET PRIOR TO DRILLING HOLES IN FIBERGLASS. BRACKET MUST BE MOUNTED SO THAT SENDER AND RECEIVER CAN BE INLINE WHILE SHOOTING THROUGH CENTER OF LENS.

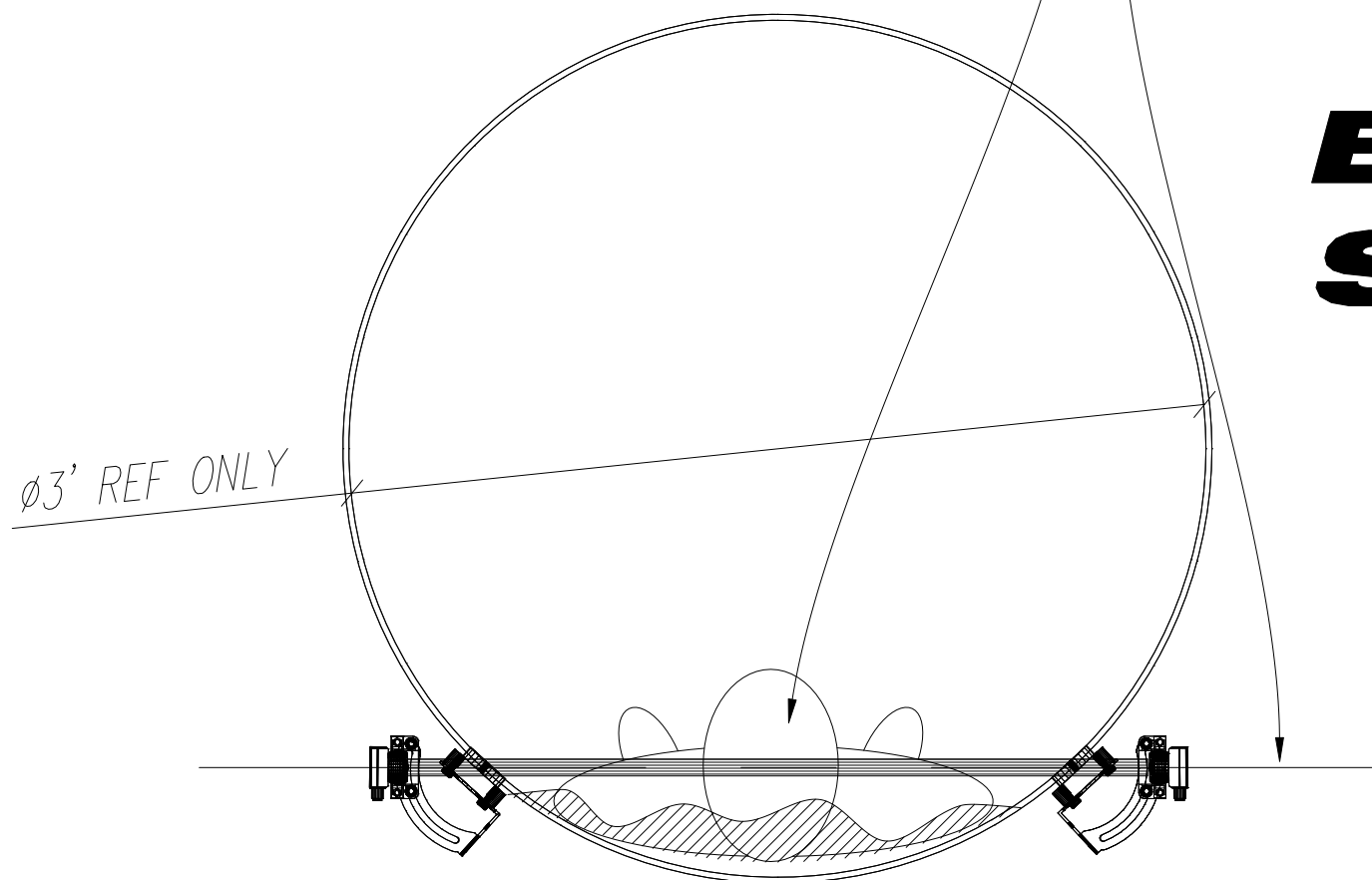

**GOOD!**

## BODY SLIDE

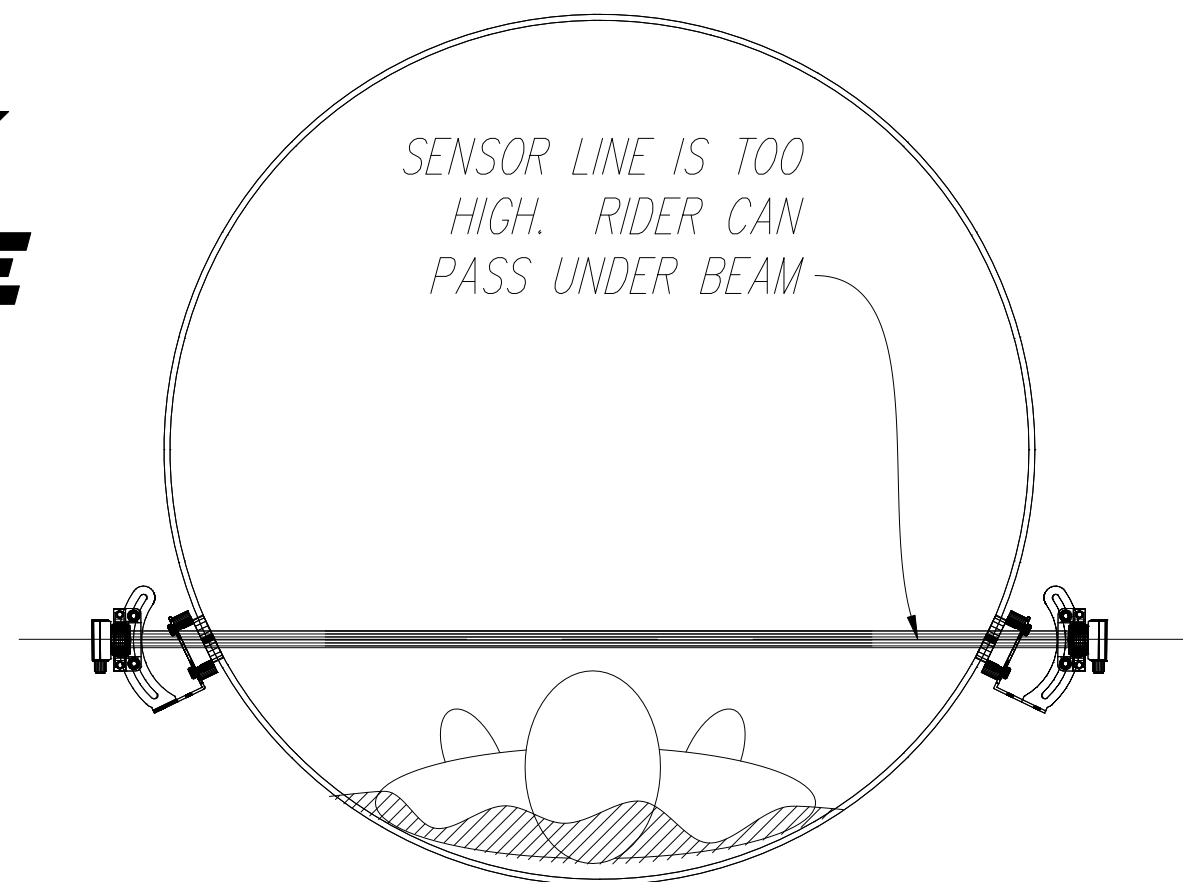

**BAD!!**

NOTES:

PRODUCT

RED LIGHT GREEN LIGHT

REV.	DATE	DESCRIPTION	BY
20	11/1/2015	EXPANDED STANDARD PRODUCT FOR ADDITIONAL OPTIONS	MS



DRAWN	MS	DATE	11/1/2015	SCALE	NONE	REV.	2.0
CHECKED	SF	DATE	12/1/2015	DRAWING TITLE		DWG. NO.	
BODY SENSOR LINE						RLGL-006	

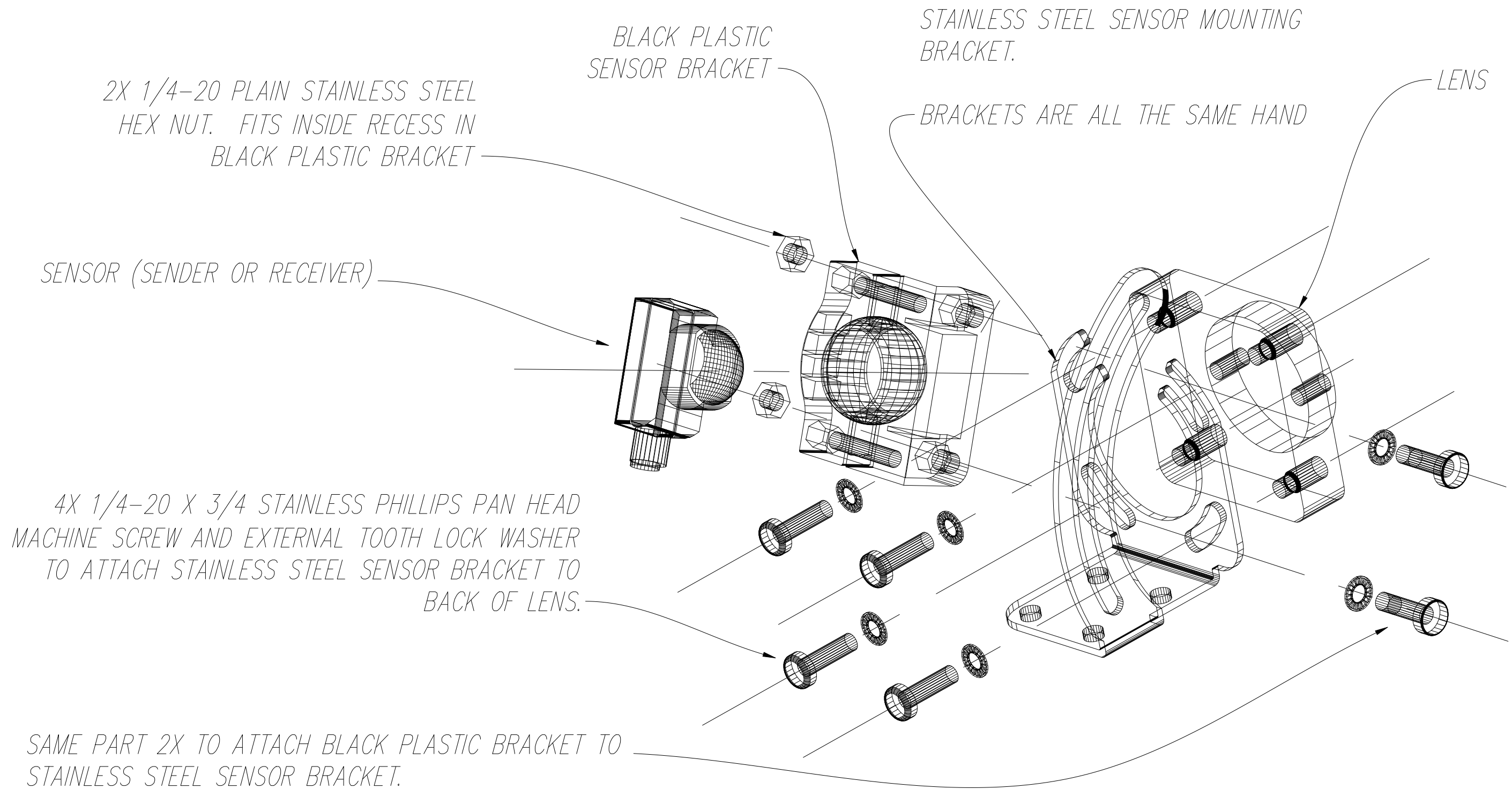

NOTES:

PRODUCT

RED LIGHT GREEN LIGHT

REV.	DATE	DESCRIPTION	BY
20	11/1/2015	EXPANDED STANDARD PRODUCT FOR ADDITIONAL OPTIONS	MS



DRAWN	MS	DATE	11/1/2015	SCALE	NONE	REV.	2.0
CHECKED	SF	DATE	12/1/2015				
DRAWING TITLE						DWG. NO.	
SENSOR AND BRACKET ASSM.						RLGL-007	

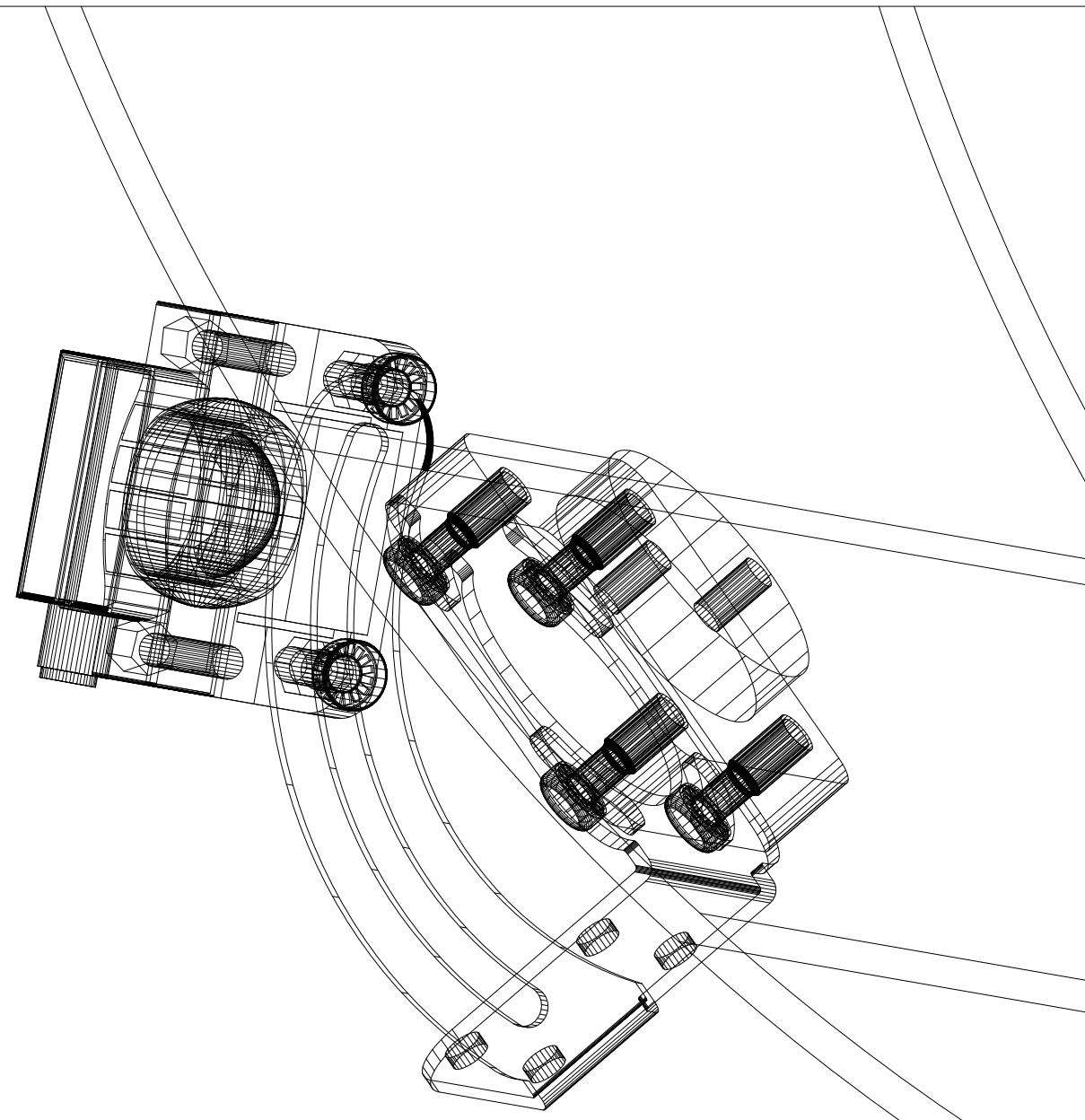

# ASSEMBLED UNIT

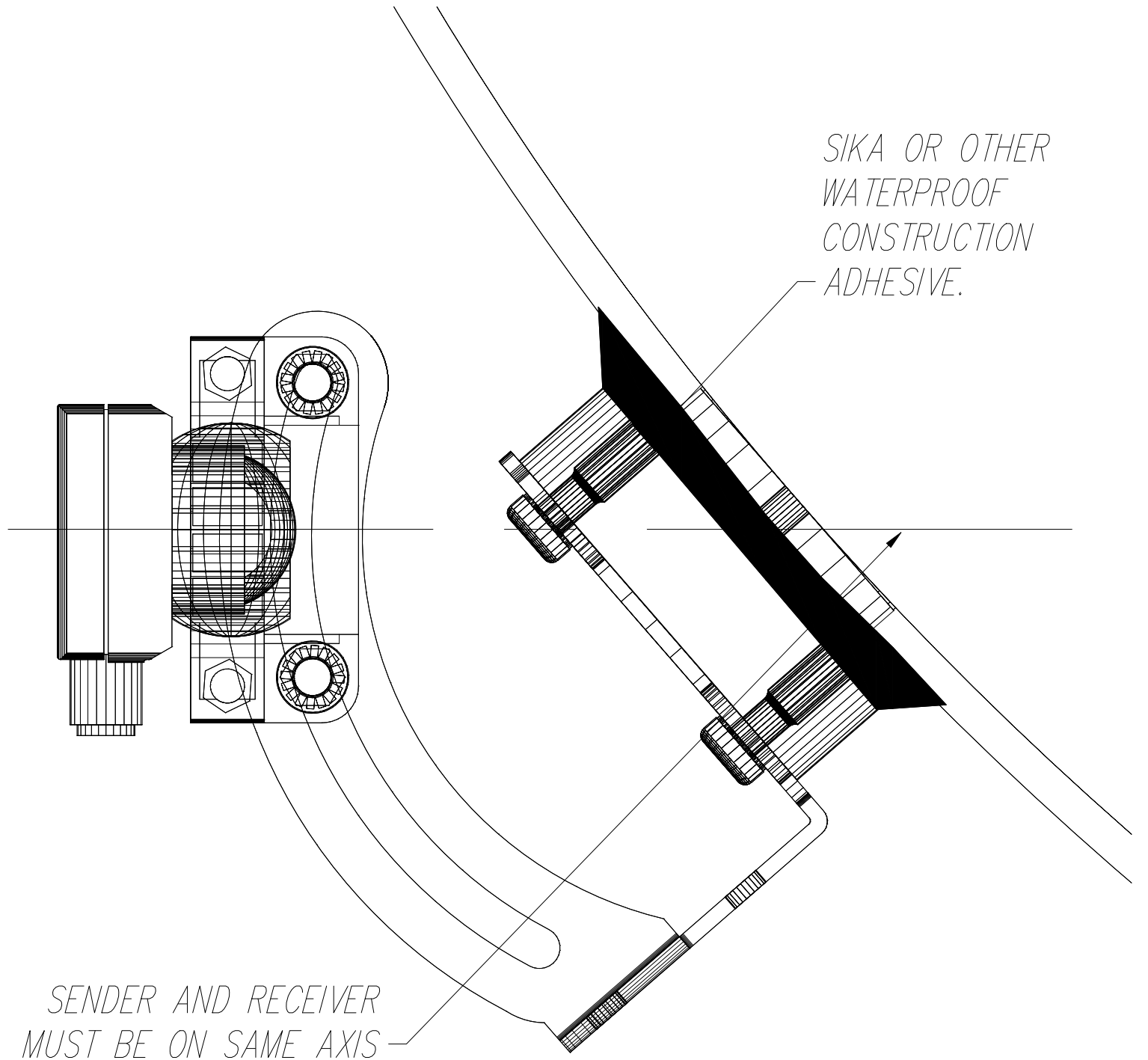

NOTES:

PRODUCT				RED LIGHT GREEN LIGHT			
DRAWN	MS	DATE	11/1/2015	SCALE	NONE	REV.	2.0
CHECKED	SF	DATE	12/1/2015				
DRAWING TITLE						DWG. NO.	
SENSOR AND BRACKET ASSM.						RLGL-008	

REV.	DATE	DESCRIPTION	BY
20	11/1/2015	EXPANDED STANDARD PRODUCT FOR ADDITIONAL OPTIONS	MS





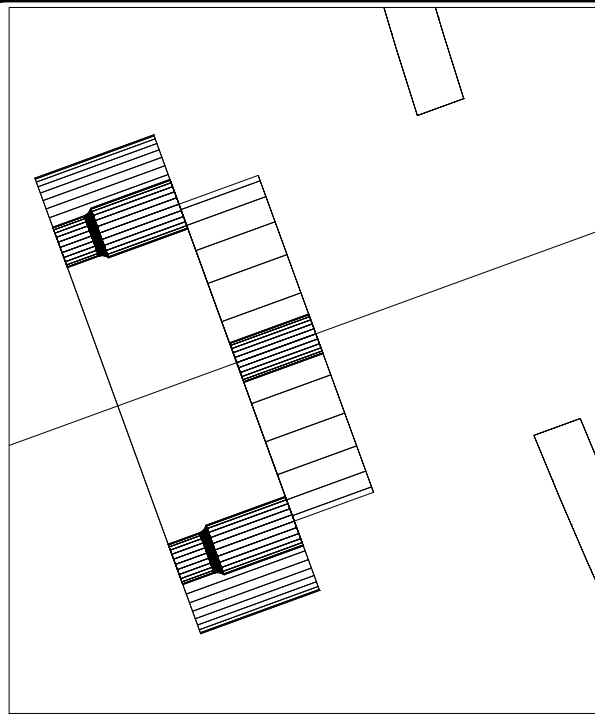

**STEP 1**

REMOVE PROTECTIVE PAPER FROM ROUND FACE OF LENS (SAVE FOR REINSTALLATION) & INSERT LENS INTO 2" DIA. HOLE.

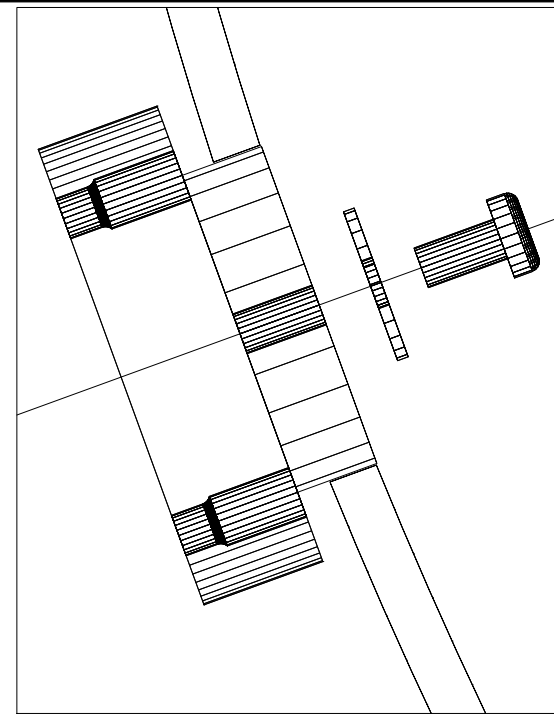

**STEP 2**

REINSTALL PROTECTIVE PAPER AND INSTALL TWO (2) ZINC PLATED 1/4-20 X 1/2 MACHINE SCREWS & FLAT WASHERS.

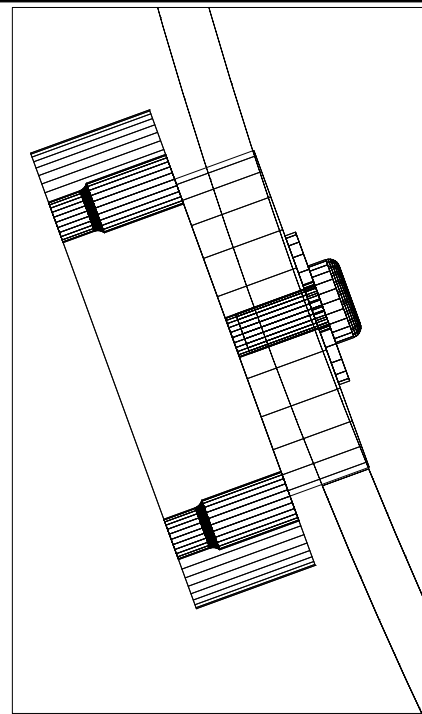

**STEP 3**

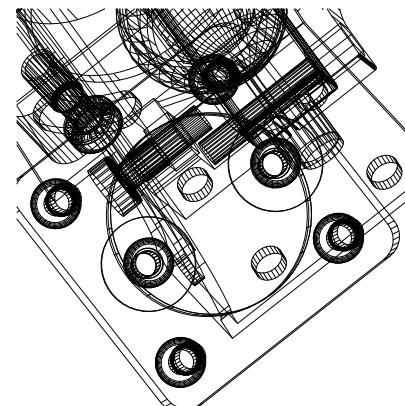

LIGHTLY TIGHTEN SCREW INTO LENS FACE UNTIL FLUSH WITH FACE OF LENS. DO NOT OVERTIGHTEN!

FILL AREA BETWEEN LENS BODY AND OUTSIDE DIAMETER OF GLASS WITH SIKAFLEX OR OTHER HIGH STRENGTH WATERPROOF CONSTRUCTION ADHESIVE. LET CURE, THEN PROCEED TO STEP 6.

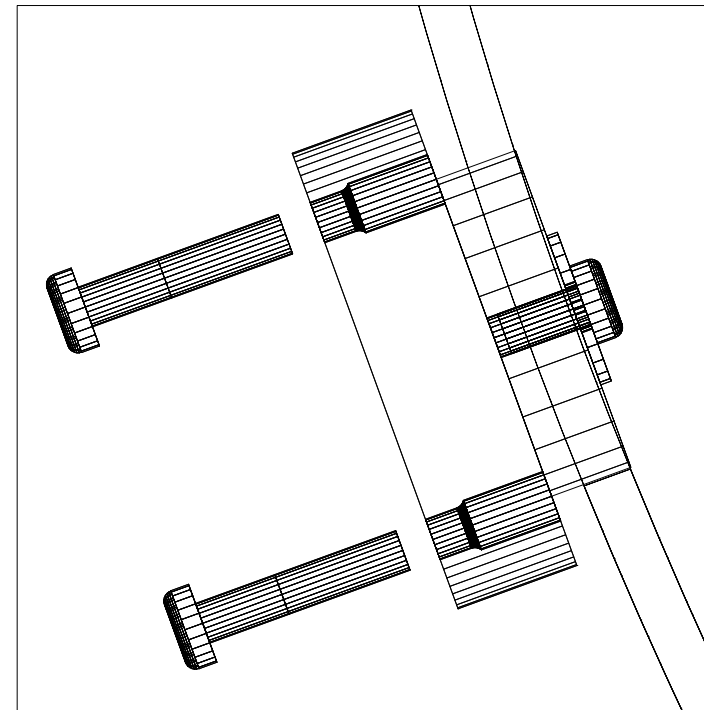

**STEP 4**

INSTALL FOUR (4) 1/4-20 X 1 1/2" PLAIN STEEL TEMPORARY LEVELING/HOLDING SCREWS. FINGER TIGHTEN SCREWS SO THAT LENSES BODY IS PULLED BACK & FENDER WASHERS ARE TIGHT AGAINST THE INSIDE FACE OF THE GLASS. WARNING, DO NOT OVERTIGHTEN AS IT WILL STRIP OUT SCREWS IN FACE OF LENSES. PUT A VERY LIGHT COAT OF NEVER-SEZE OR GREASE ON SCREW THREADS FOR EASY REMOVAL AFTER BONDING ADHESIVE DRIES.

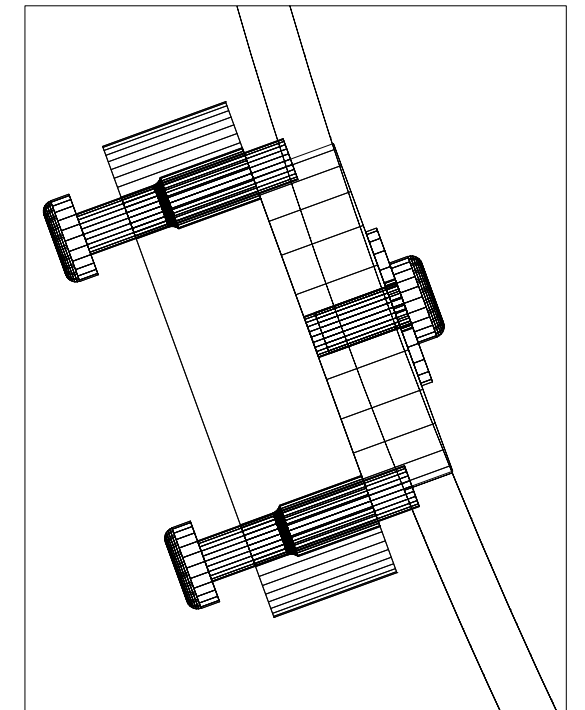

**STEP 5**

**STEP 6**

ONCE ADHESIVE CURES, REMOVE LONGER OUTSIDE LEVELING SCREWS & PROTECTIVE PAPER & INSTALL SENSORS & BRACKETS ACCORDING TO DRAWINGS LL-506 & LL-507. REMOVE INSIDE SCREWS & PAPER LAST.

NOTES:

REV.	DATE	DESCRIPTION	BY
20	11/1/2015	EXPANDED STANDARD PRODUCT FOR ADDITIONAL OPTIONS	MS



PRODUCT				RED LIGHT GREEN LIGHT			
DRAWN	MS	DATE	11/1/2015	SCALE	NONE	REV.	2.0
CHECKED	SF	DATE	12/1/2015				
DRAWING TITLE						DWG. NO.	
LENS INSTALLATION						RLGL-009	

**FIELD**

**UPPER JB**

**CONTROL BOX**

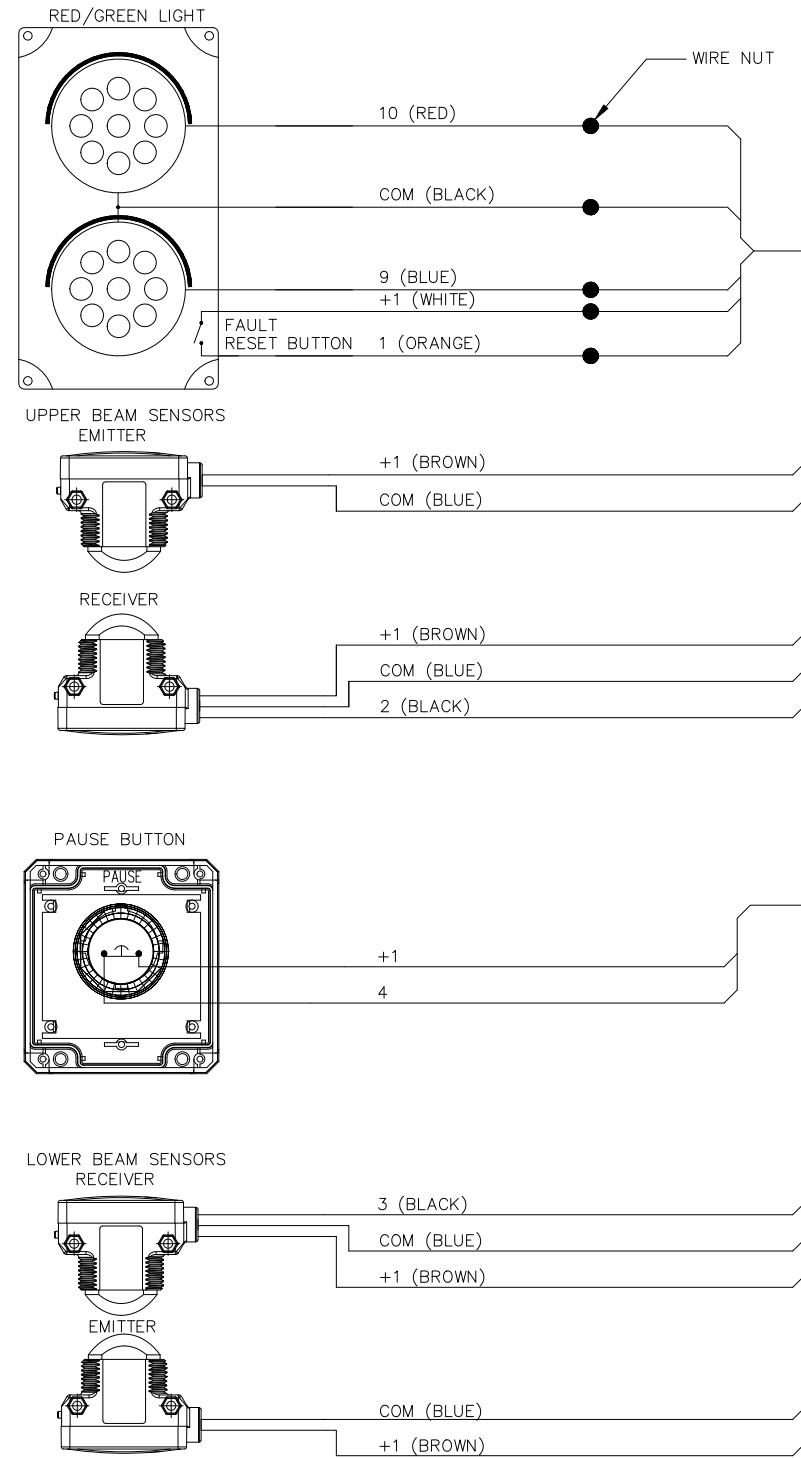

NOTE 1

NOTE 2

NOTE 1

NOTE 2

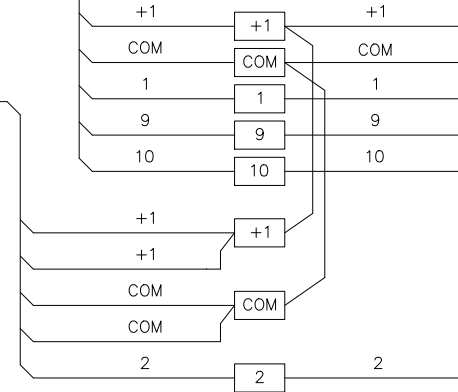

**LOWER JB**

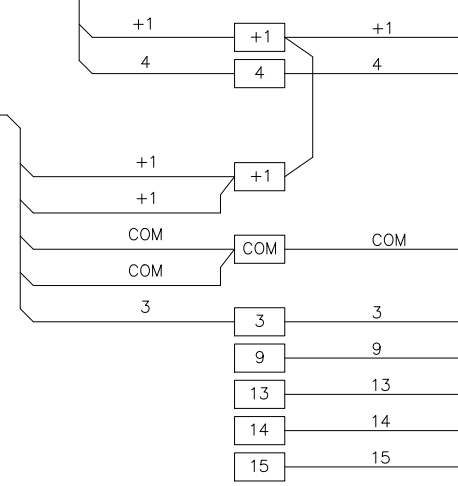

NOTE 1

NOTE 1

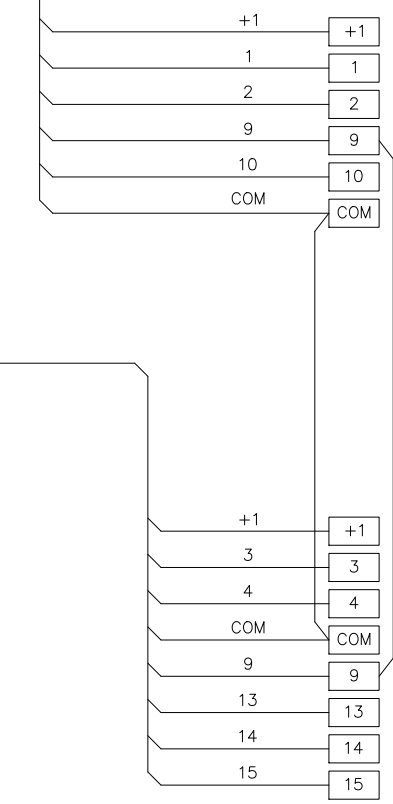

- NOTES:**
1. CUSTOMER SUPPLIED WIRING
  2. PRE-WIRED FROM FACTORY

PRODUCT *RED LIGHT GREEN LIGHT*

REV.	DATE	DESCRIPTION	BY
20	11/1/2015	EXPANDED STANDARD PRODUCT FOR ADDITIONAL OPTIONS	MS



DRAWN	MS	DATE	11/1/2015	SCALE	NONE	REV.	2.0
CHECKED	SF	DATE	12/1/2015				
DRAWING TITLE						DWG. NO.	
<b>INTERCONNECTION DIAGRAM</b>						<b>RLGL-010</b>	

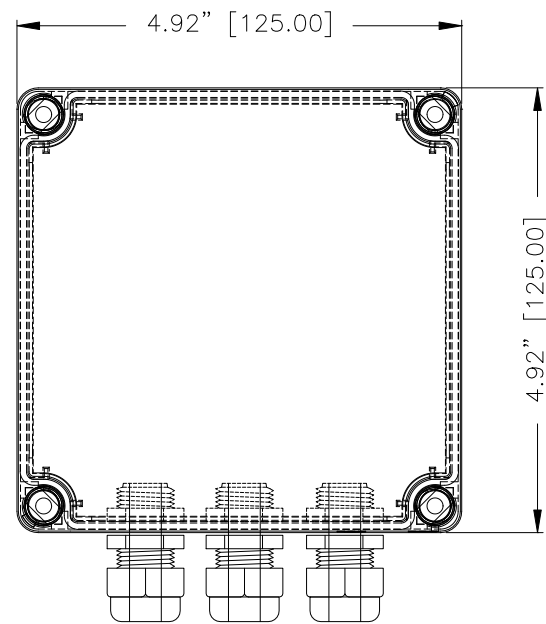

FRONT VIEW

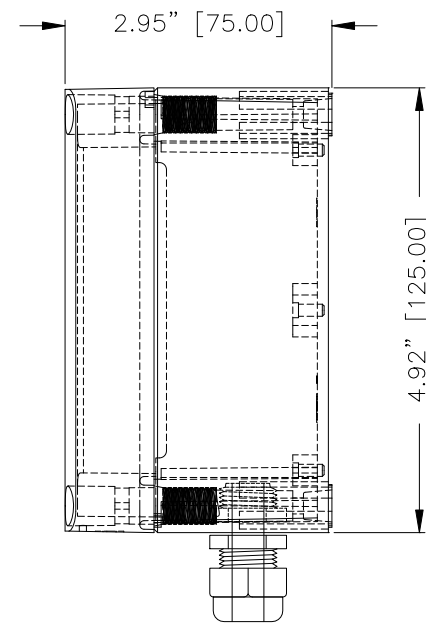

SIDE VIEW

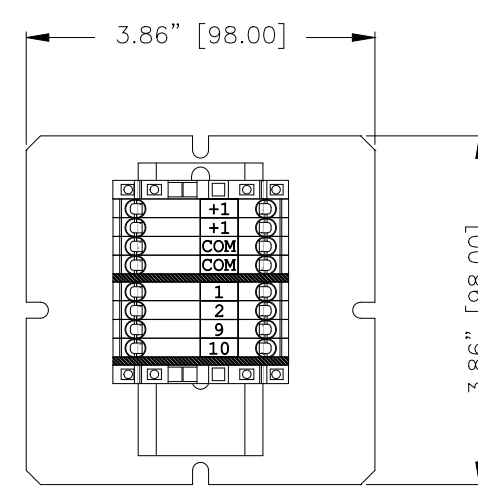

BACK PANEL VIEW

NOTES:

REV.	DATE	DESCRIPTION	BY
20	11/1/2015	EXPANDED STANDARD PRODUCT FOR ADDITIONAL OPTIONS	MS



PRODUCT				RED LIGHT GREEN LIGHT			
DRAWN	MS	DATE	11/1/2015	SCALE	NONE	REV.	2.0
CHECKED	SF	DATE	12/1/2015				
DRAWING TITLE						DWG. NO.	
UPPER J-BOX						RLGL-011	

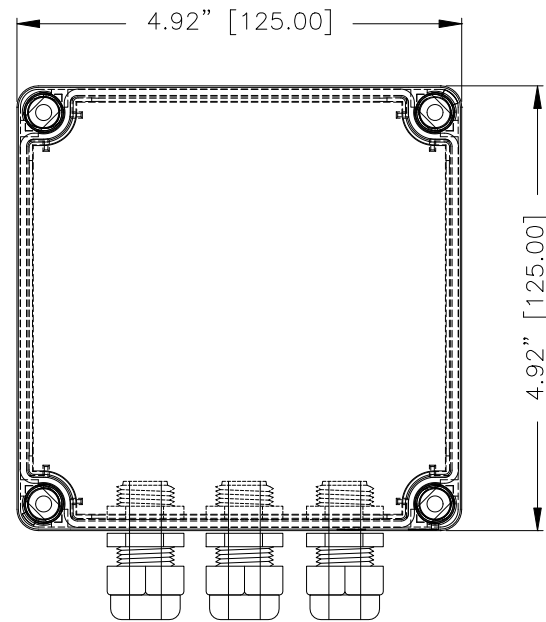

FRONT VIEW

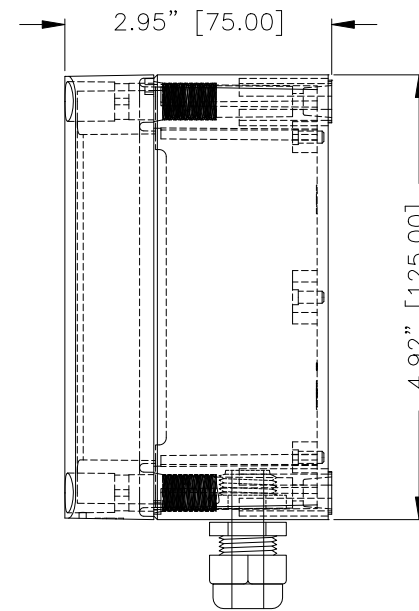

SIDE VIEW

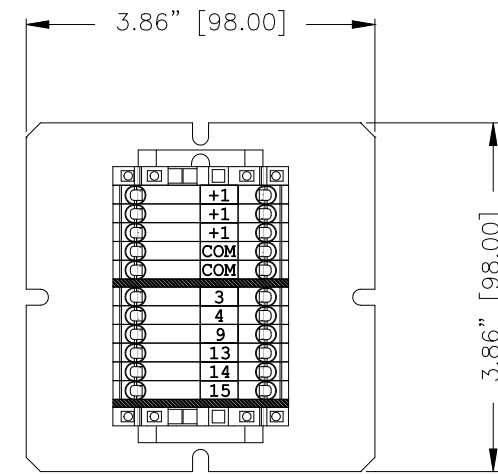

BACK PANEL VIEW

NOTES:

REV.	DATE	DESCRIPTION	BY
20	11/1/2015	EXPANDED STANDARD PRODUCT FOR ADDITIONAL OPTIONS	MS



PRODUCT

RED LIGHT GREEN LIGHT

DRAWN	MS	DATE	11/1/2015	SCALE	NONE	REV.	2.0
CHECKED	SF	DATE	12/1/2015				
DRAWING TITLE						DWG. NO.	
LOWER J-BOX						RLGL-012	

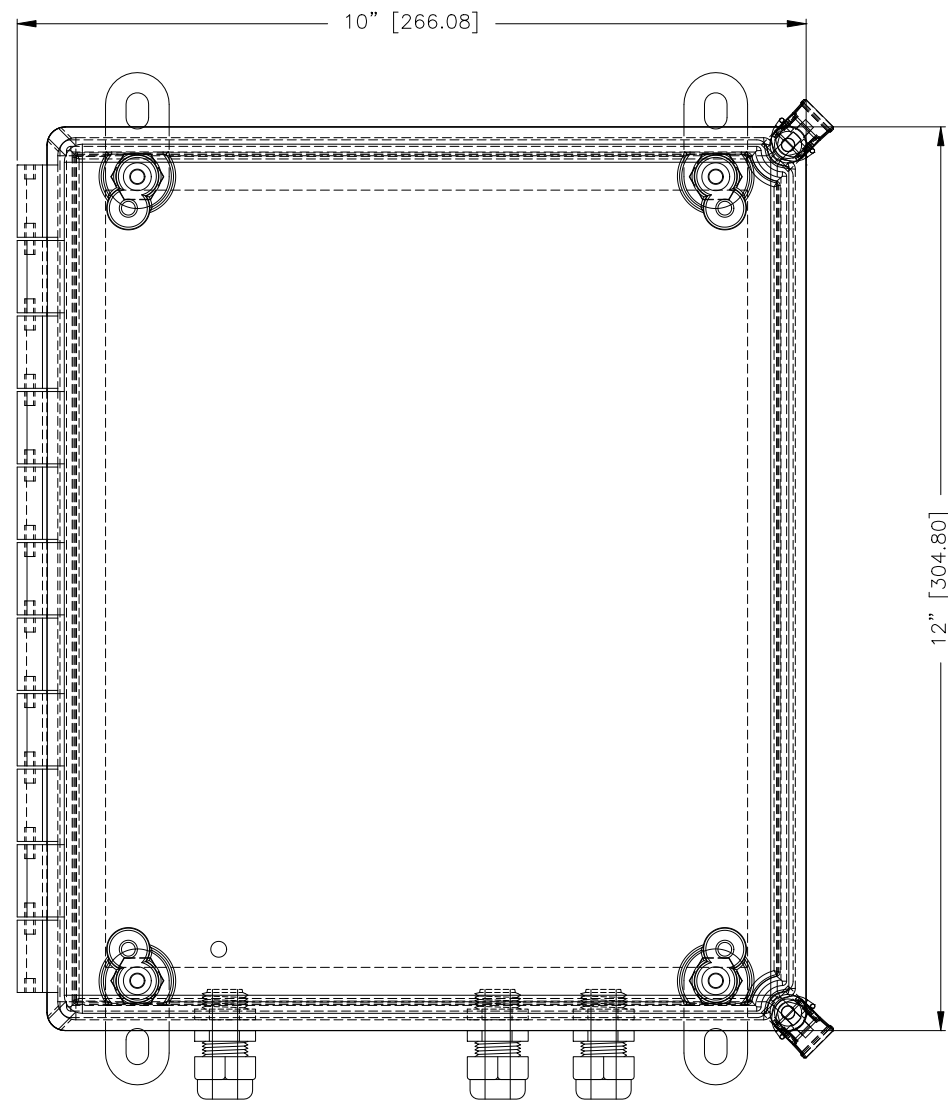

FRONT VIEW

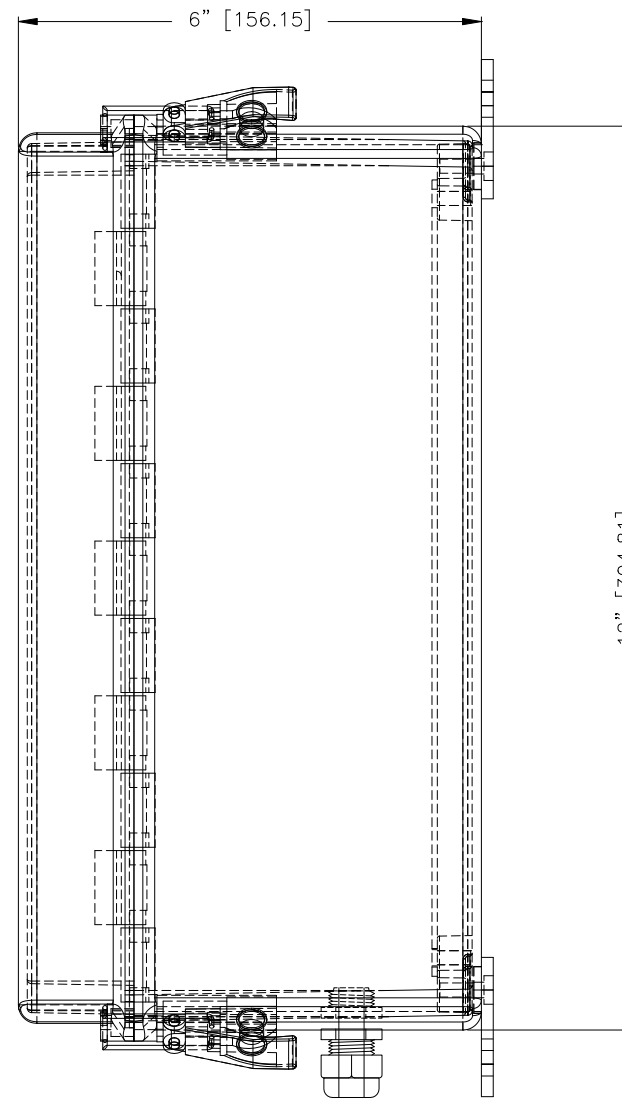

SIDE VIEW

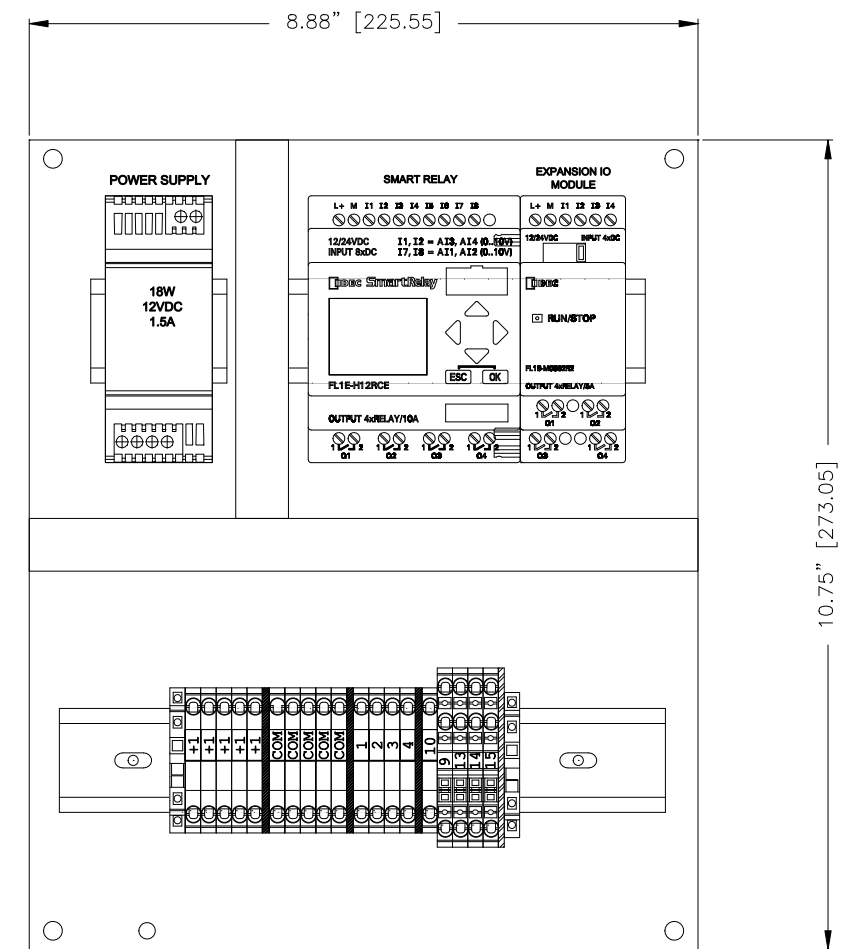

BACK PANEL VIEW

NOTES:

PRODUCT

RED LIGHT GREEN LIGHT

REV.	DATE	DESCRIPTION	BY
20	11/1/2015	EXPANDED STANDARD PRODUCT FOR ADDITIONAL OPTIONS	MS



DRAWN	MS	DATE	11/1/2015	SCALE	NONE	REV.	2.0
CHECKED	SF	DATE	12/1/2015				
DRAWING TITLE						DWG. NO.	
CONTROL BOX						RLGL-013	

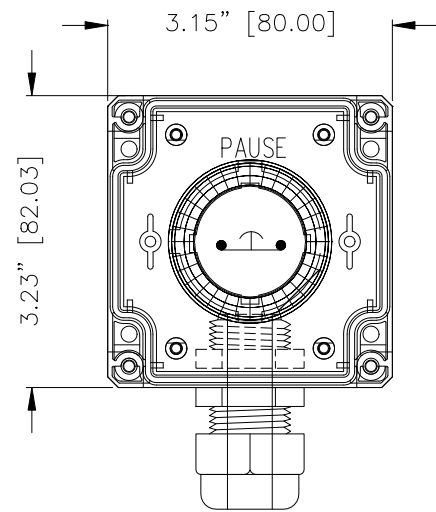

FRONT VIEW

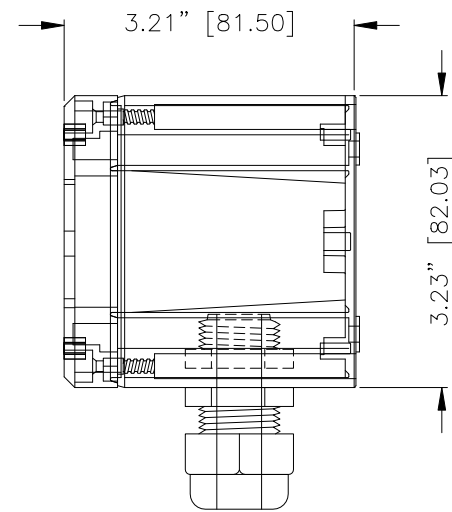

SIDE VIEW

SCHMATIC

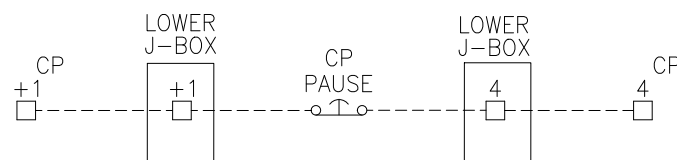

WIRING DETAILS

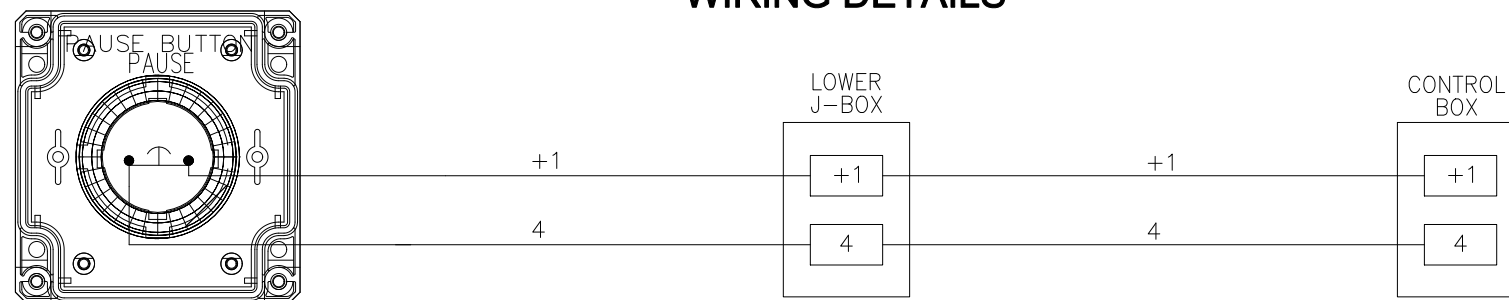

NOTES:

PRODUCT

RED LIGHT GREEN LIGHT

REV.	DATE	DESCRIPTION	BY
20	11/1/2015	EXPANDED STANDARD PRODUCT FOR ADDITIONAL OPTIONS	MS



DRAWN	MS	DATE	11/1/2015	SCALE	NONE	REV.	2.0
CHECKED	SF	DATE	12/1/2015				
DRAWING TITLE						DWG. NO.	
PAUSE BUTTON						RLGL-014	

**RED/GREEN LIGHT**

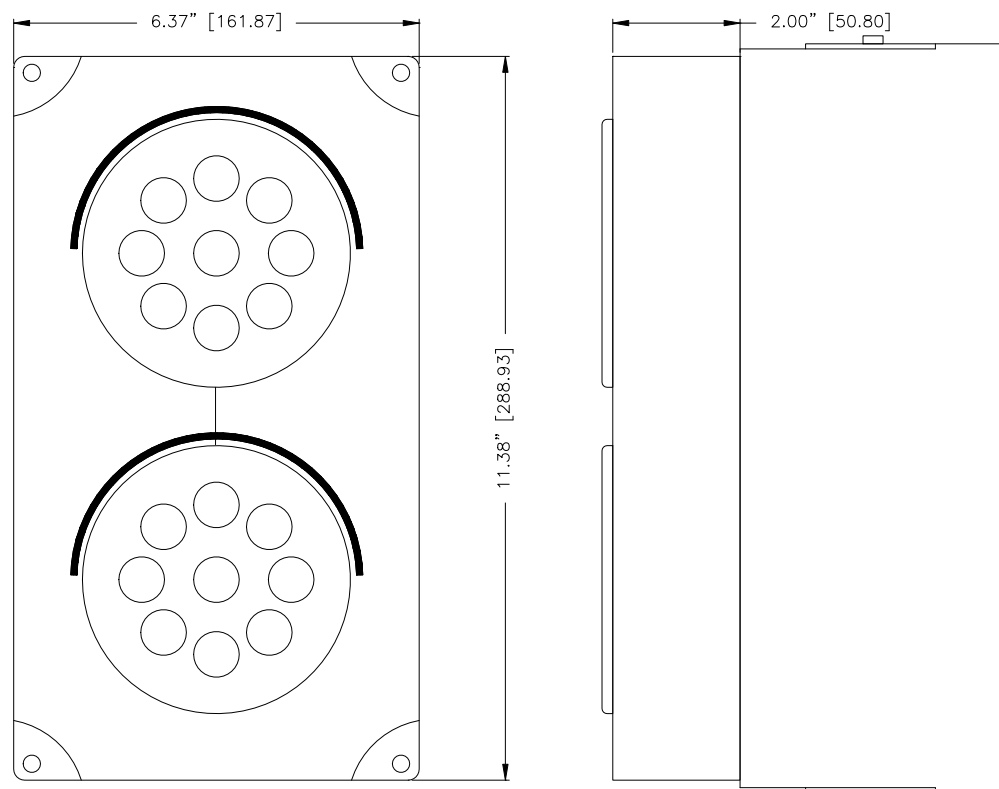

**FRONT VIEW**

**SIDE VIEW WITH BRACKET**

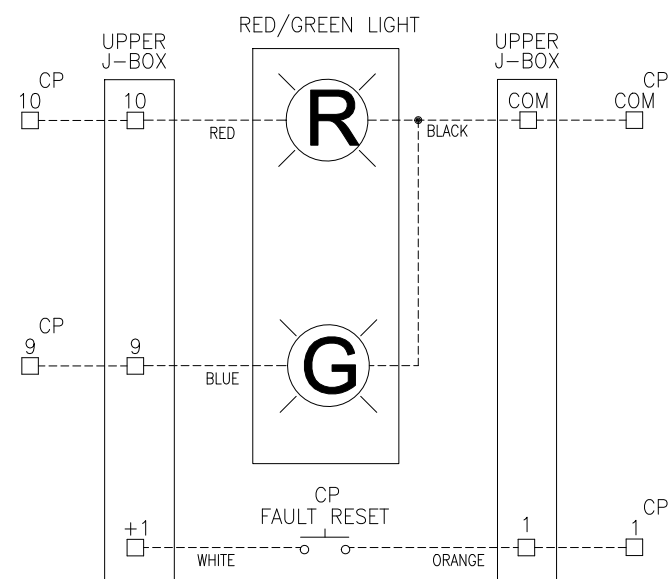
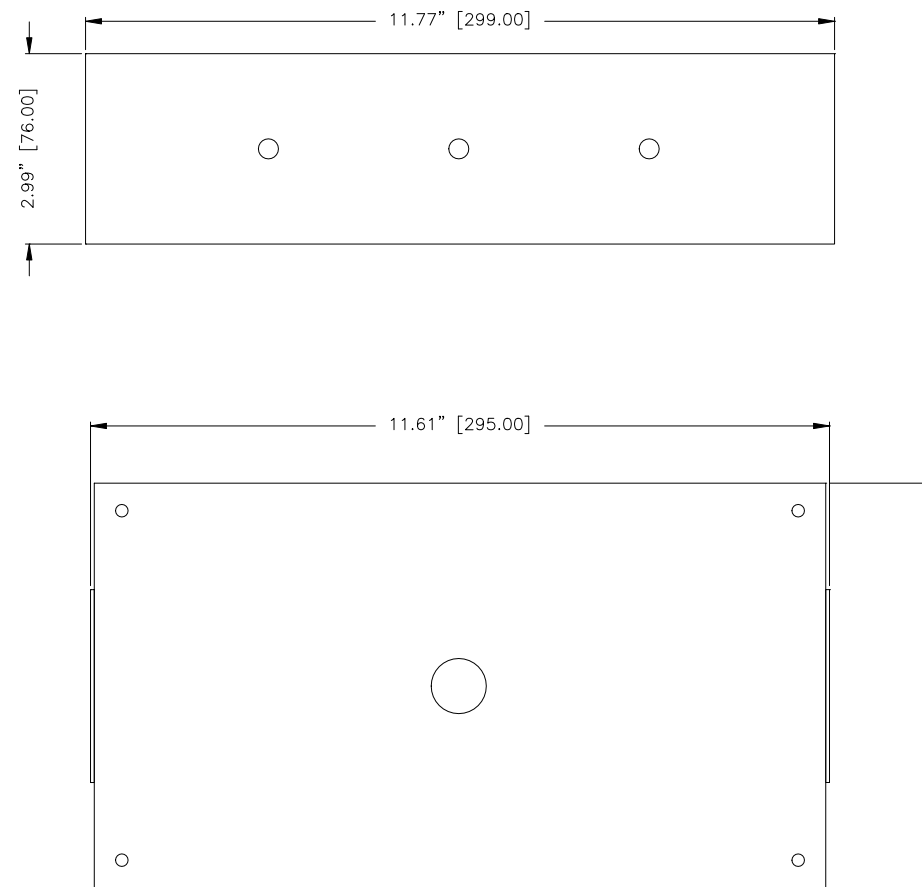
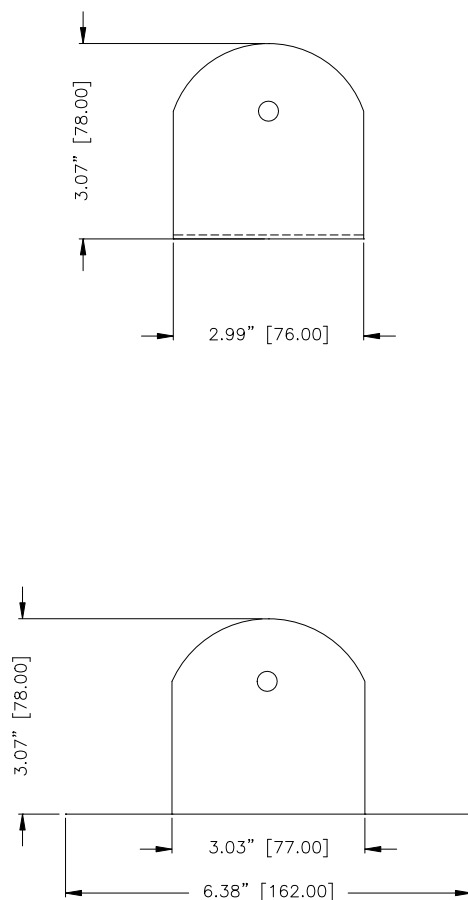

**SCHEMATIC**

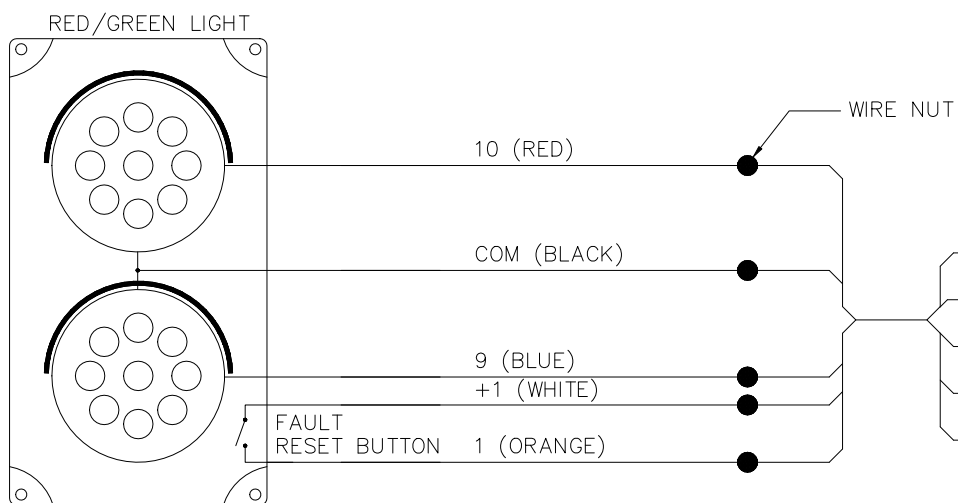

**LIGHT BRACKETS**

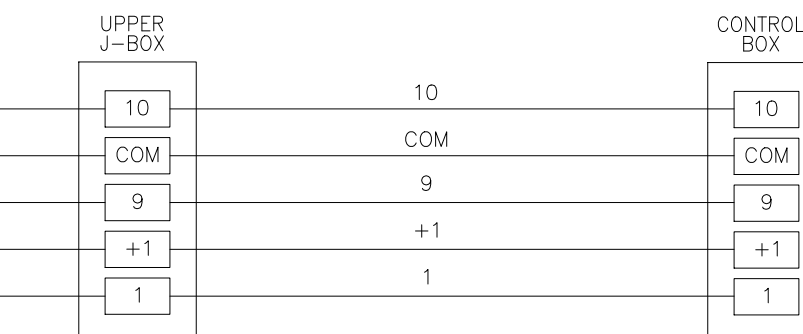

**WIRING DETAILS**

**NOTES:**

**PRODUCT**

*RED LIGHT GREEN LIGHT*

REV.	DATE	DESCRIPTION	BY
20	11/1/2015	EXPANDED STANDARD PRODUCT FOR ADDITIONAL OPTIONS	MS



<b>DRAWN</b>	MS	<b>DATE</b>	11/1/2015	<b>SCALE</b>	NONE	<b>REV.</b>	2.0
<b>CHECKED</b>	SF	<b>DATE</b>	12/1/2015				
<b>DRAWING TITLE</b>						<b>DWG. NO.</b>	
<b>RED/GREEN LIGHT</b>						<b>RLGL-015</b>	

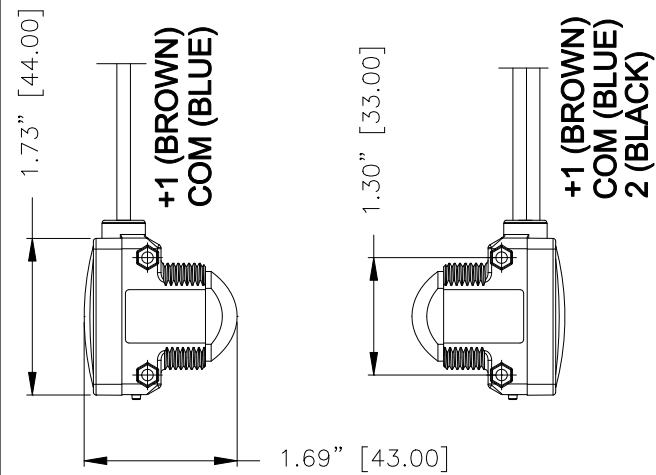

**EMITTER**  
**RECEIVER**  
**UPPER BEAM SENSORS**

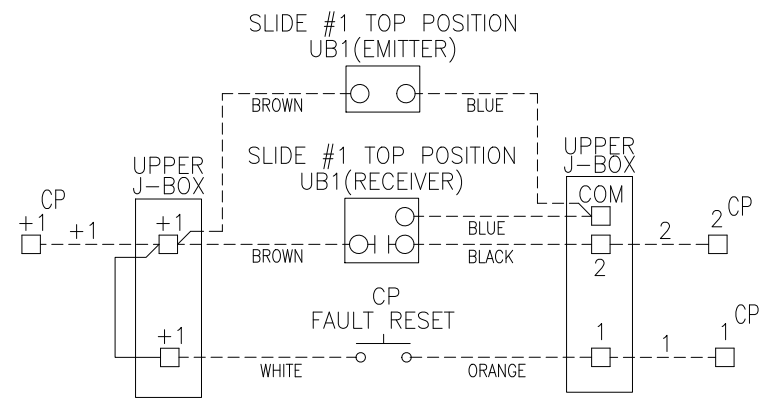

**SCHEMATIC**  
**UPPER BEAM SENSORS**

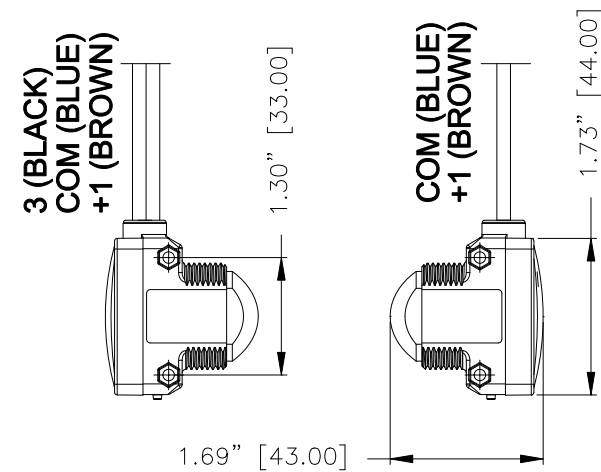

**RECEIVER**  
**EMITTER**  
**LOWER BEAM SENSORS**

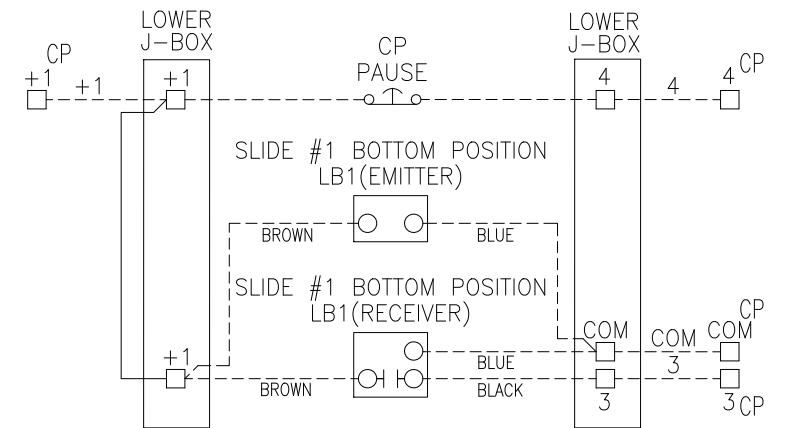

**SCHEMATIC**  
**LOWER BEAM SENSORS**

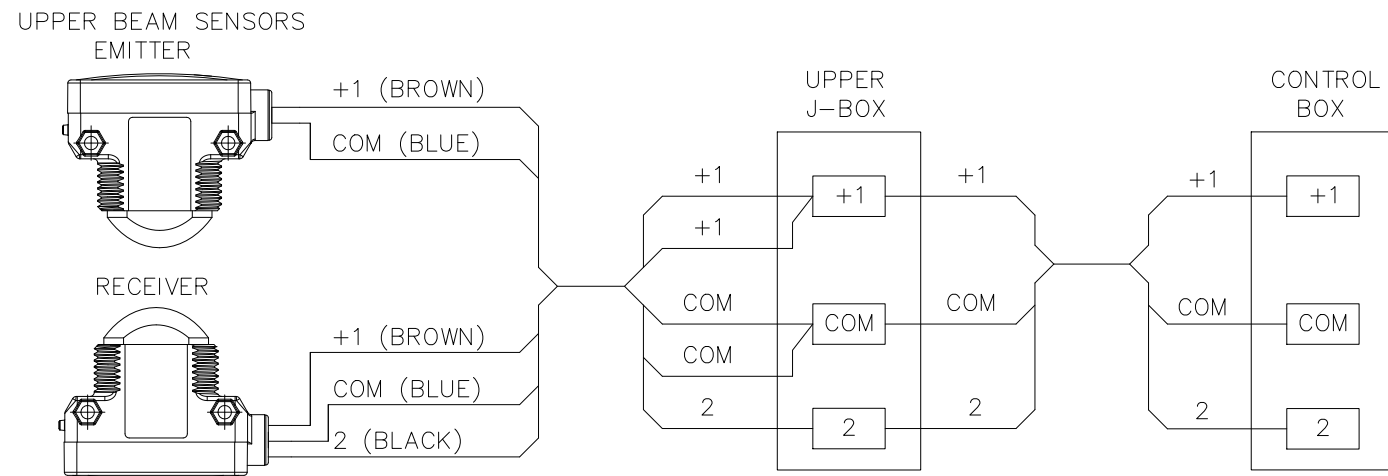

**WIRING DETAILS FOR**  
**UPPER BEAM SENSORS**

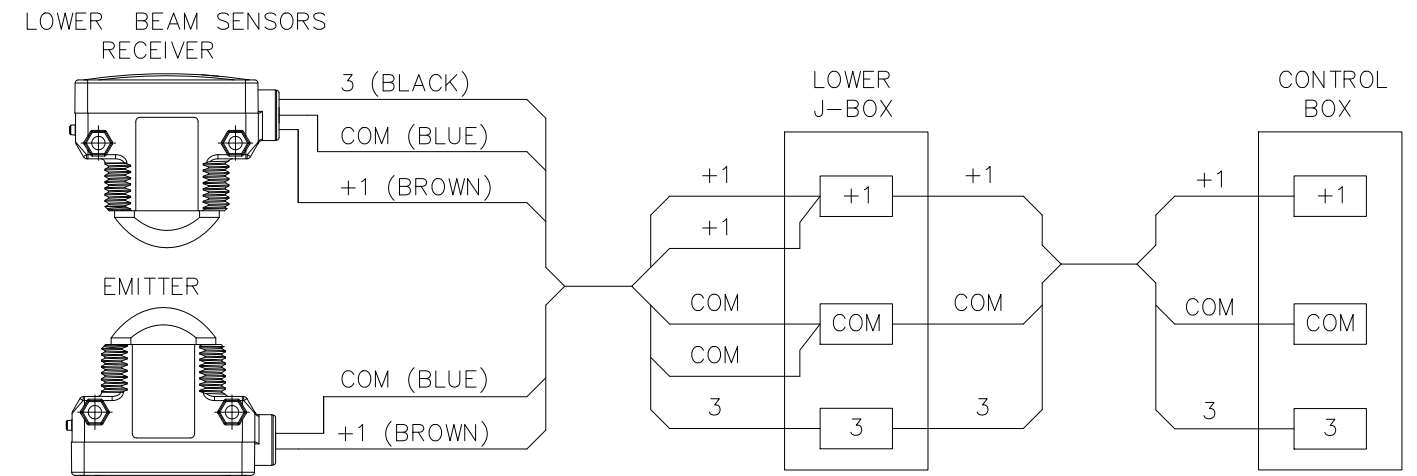

**WIRING DETAILS FOR**  
**LOWER BEAM SENSORS**

NOTES:

PRODUCT

RED LIGHT GREEN LIGHT

REV.	DATE	DESCRIPTION	BY
20	11/1/2015	EXPANDED STANDARD PRODUCT FOR ADDITIONAL OPTIONS	MS



DRAWN	DATE	SCALE	REV.
MS	11/1/2015	NONE	2.0
DRAWING TITLE		DWG. NO.	
ACCESSORIES		RLGL-016	



1  
2  
3  
4  
5  
6  
7  
8  
9  
10  
11  
12  
13  
14  
15  
16  
17

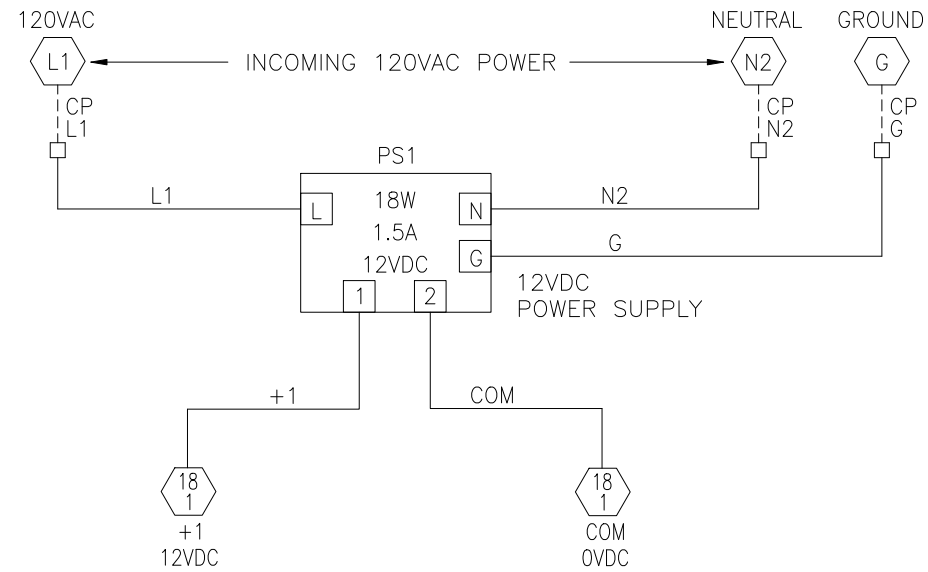

18  
19  
20  
21  
22  
23  
24  
25  
26  
27  
28  
29  
30  
31  
32  
33  
34

**NOTES:** RECOMMENDED FIELD WIRE: USE 18-GAUGE 8 CONDUCTOR DIRECT BURIAL CABLE OR COMPARABLE  
 PRE WIRED \_\_\_\_\_  
 FIELD WIRE -----

PRODUCT  
 RED LIGHT GREEN LIGHT

REV.	DATE	DESCRIPTION	BY
20	11/1/2015	EXPANDED STANDARD PRODUCT FOR ADDITIONAL OPTIONS	MS



DRAWN	MS	DATE	11/1/2015	SCALE	NONE	REV.	2.0
CHECKED	SF	DATE	12/1/2015	DRAWING TITLE		DWG. NO.	
				SCHEMATIC		RLGL-017	

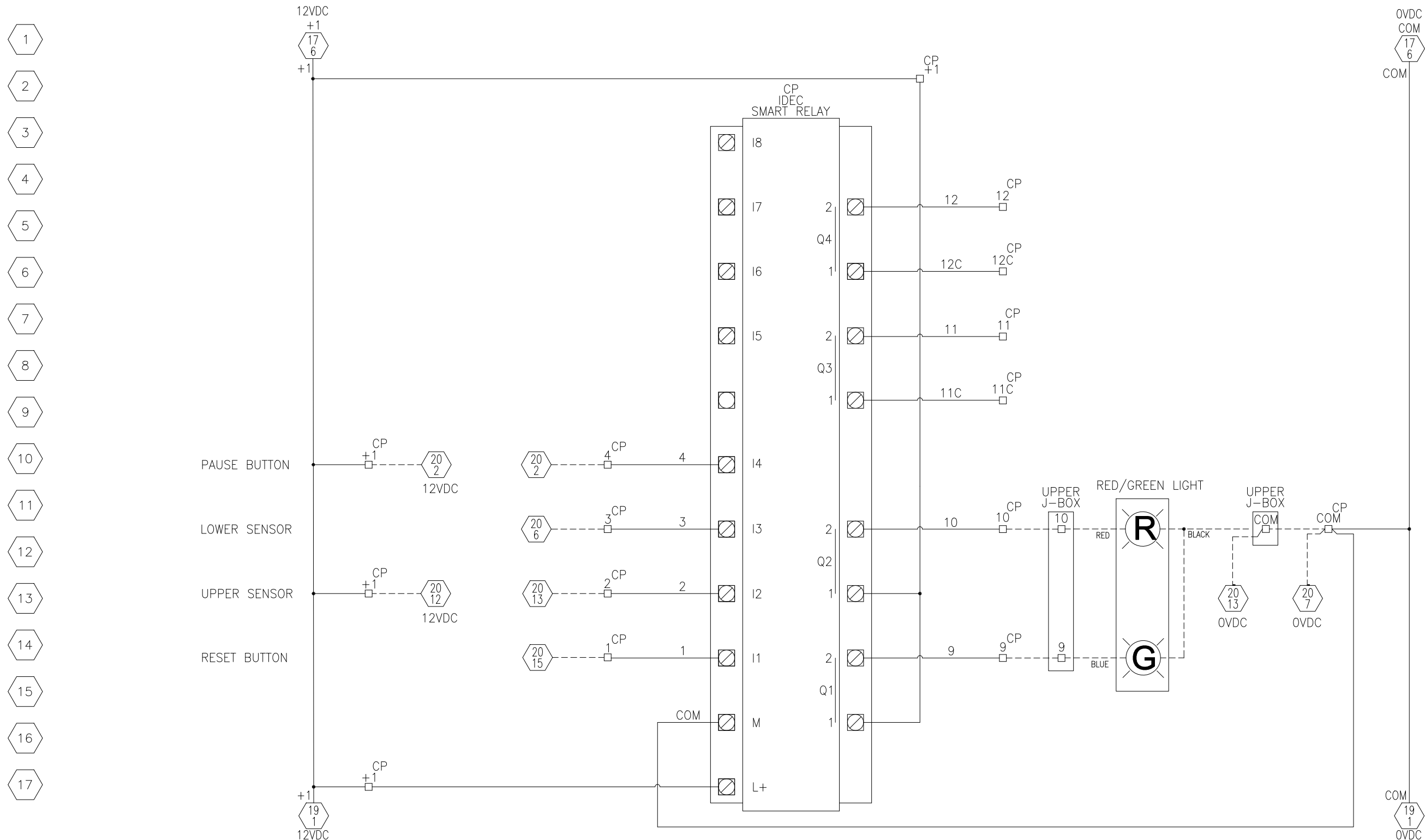

**NOTES:** RECOMMENDED FIELD WIRE: USE 18-GAUGE 8 CONDUCTOR DIRECT BURIAL CABLE OR COMPARABLE

PRE WIRED \_\_\_\_\_  
 FIELD WIRE - - - - -

PRODUCT *RED LIGHT GREEN LIGHT*

REV.	DATE	DESCRIPTION	BY
20	11/1/2015	EXPANDED STANDARD PRODUCT FOR ADDITIONAL OPTIONS	MS



DRAWN	MS	DATE	11/1/2015	SCALE	NONE	REV.	2.0
CHECKED	SF	DATE	12/1/2015				
DRAWING TITLE						DWG. NO.	
<b>SCHEMATIC</b>						<b>RLGL-018</b>	



- 1
- 2
- 3
- 4
- 5
- 6
- 7
- 8
- 9
- 10
- 11
- 12
- 13
- 14
- 15
- 16
- 17

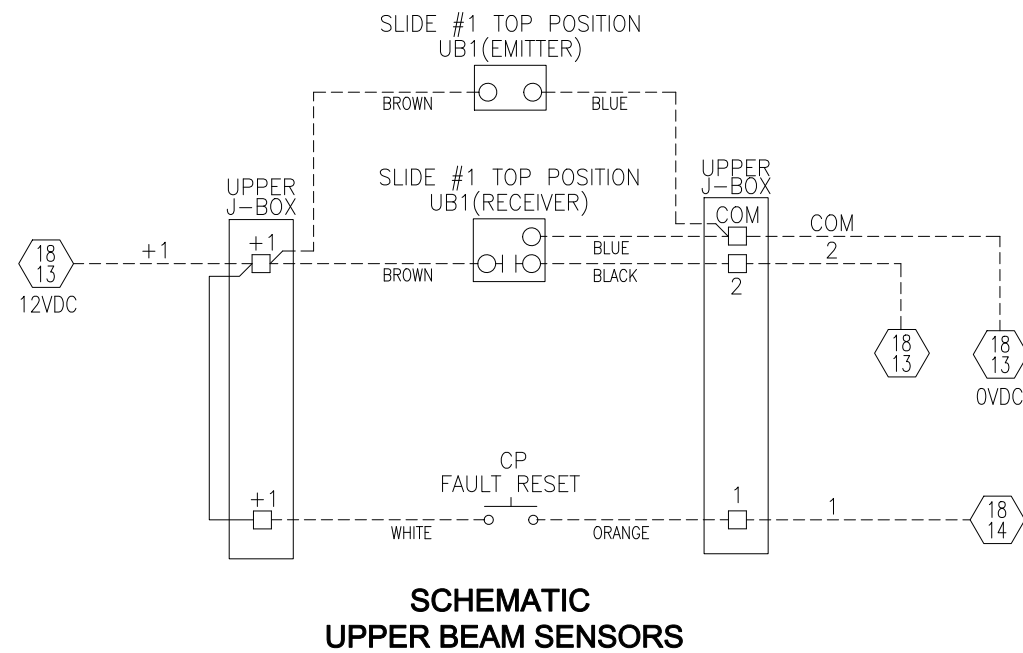
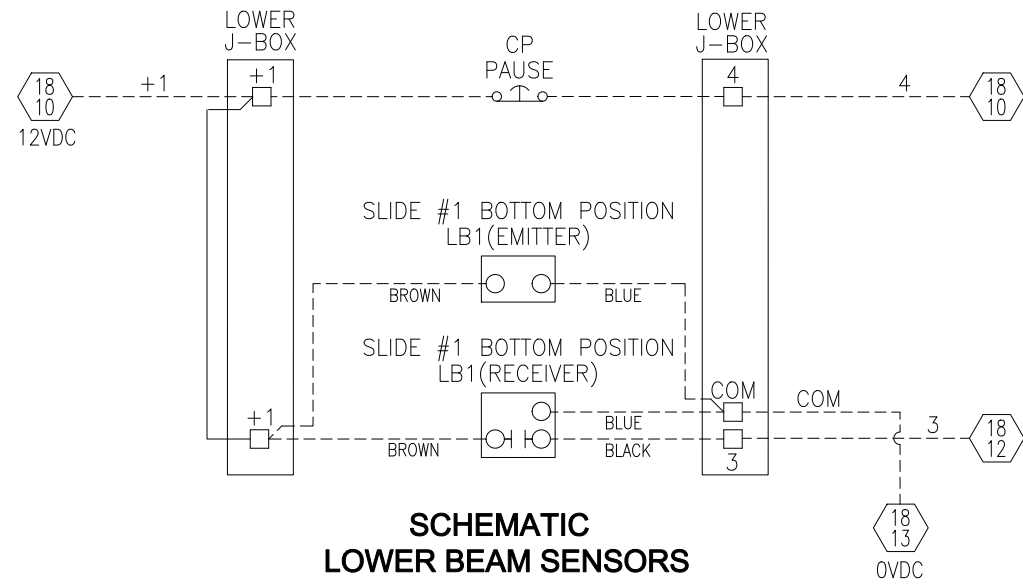

**NOTES:** RECOMMENDED FIELD WIRE: USE 18-GAUGE 8 CONDUCTOR DIRECT BURIAL CABLE OR COMPARABLE  
 PRE WIRED \_\_\_\_\_  
 FIELD WIRE \_\_\_\_\_

PRODUCT *RED LIGHT GREEN LIGHT*

REV.	DATE	DESCRIPTION	BY
20	11/1/2015	EXPANDED STANDARD PRODUCT FOR ADDITIONAL OPTIONS	MS



DRAWN	MS	DATE	11/1/2015	SCALE	NONE	REV.	2.0
CHECKED	SF	DATE	12/1/2015				
DRAWING TITLE						DWG. NO.	
<b>SCHMATIC</b>						<b>RLGL-020</b>	